

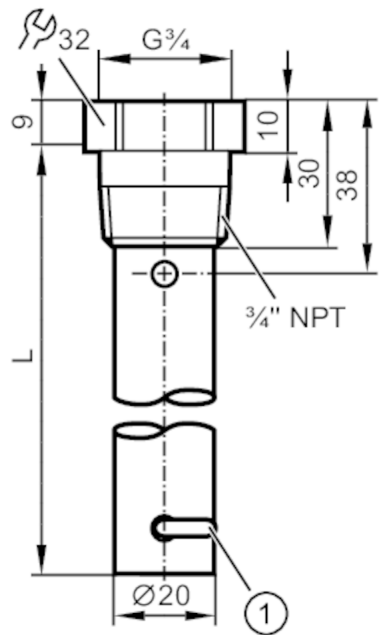

Coaxial tube for level sensors

LR COAX TUBE NPT L1200



1 fixing bracket for centering piece

Application		
Design		for level sensors LR
Medium temperature	[°C]	-40...200
Pressure rating	[bar]	16
Vacuum resistance	[mbar]	-1000
Mechanical data		
Weight	[g]	645
Material		Coaxial tubes for level sensors: stainless steel (1.4301 / 304); centring piece: PPS fiber-reinforced; fixing bracket: stainless steel (1.4310 / 301)
Sensor connection		threaded connection G 3/4 Internal thread
Process connection		threaded connection 3/4" NPT external thread
Length L	[mm]	1200
Remarks		
Pack quantity		1 pcs.