

# E43013

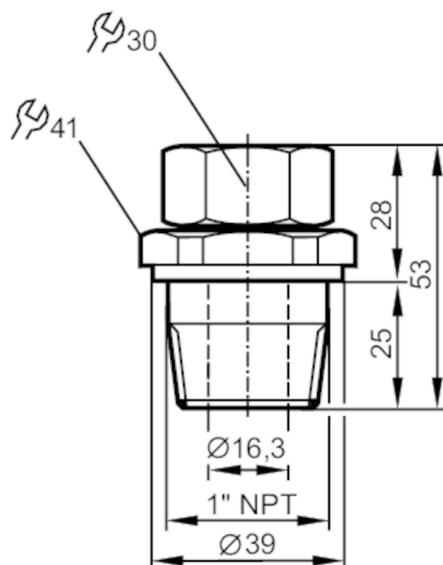

## Clamp fitting for process sensors

MOUNTING ADAPTER NPT1/D16



Application		
Design		for capacitive level sensors LK, LI, LT, LL
Installation		Clamp fitting
Pressure rating	[bar]	0.5
Operating conditions		
Ambient temperature	[°C]	0...80
Mechanical data		
Weight	[g]	327
Dimensions	[mm]	Ø 39 / L = 53
Material		flange: stainless steel; knurled nut: stainless steel; Spacer: brass; clamping ring: FKM
Tightening torque	[Nm]	6...9
Sensor connection		Ø 16 mm
Process connection		threaded connection 1" NPT external thread
Remarks		
Pack quantity		1 pcs.