

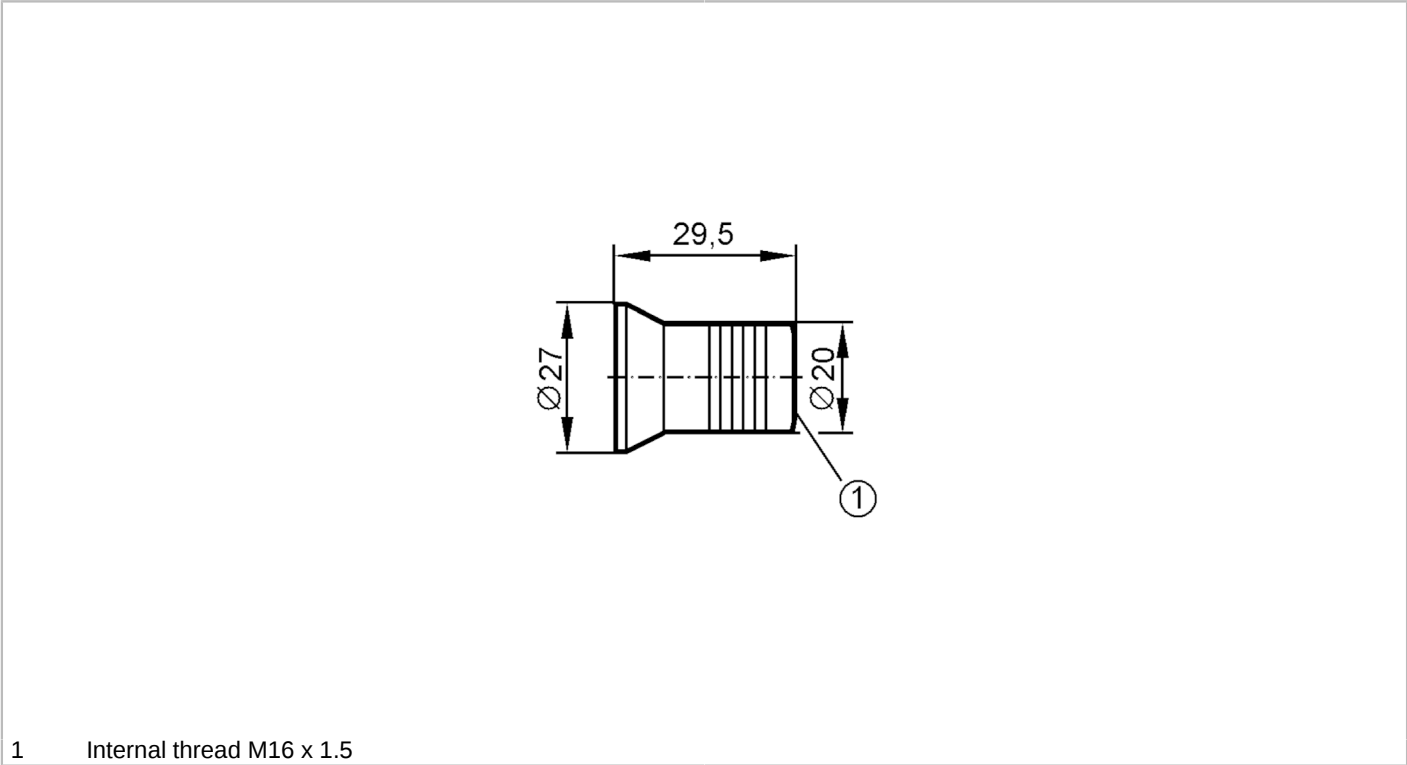

Welding adapter for process sensors

Einschweißmuffe/Ms/SA

Article no longer available - archive entry



Tests / approvals

Pressure equipment directive	A possible classification to PED depends on the application and has to be carried out by the user / operator.
Safety instructions	The compatibility between medium and product material has to be checked in all applications.

Mechanical data

Dimensions [mm]	M16
Thread designation	M16
Material	brass (2.0401)

Remarks

Pack quantity	1 pcs.
---------------	--------