

# E35210

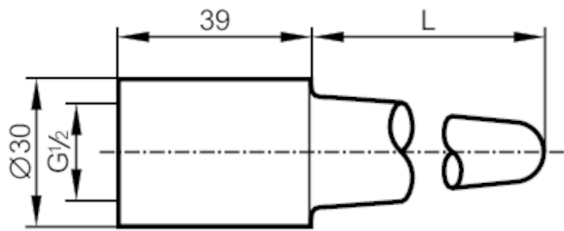

## Welding thermowell for temperature sensors

WELDING THERMOWELL G1/2



Application		
Design		for temperature sensors EL = 100 mm
Pressure rating	[bar]	100
Measuring/setting range		
Probe length L	[mm]	73
Mechanical data		
Weight	[g]	315.7
Dimensions	[mm]	Ø 10
Material		stainless steel (1.4571/316Ti )
Sensor connection		G 1/2
Process connection		Welding adapter Ø 30 mm
Surface characteristics Ra/Rz of the wetted parts		< 0.6 / -
Remarks		
Pack quantity		1 pcs.