

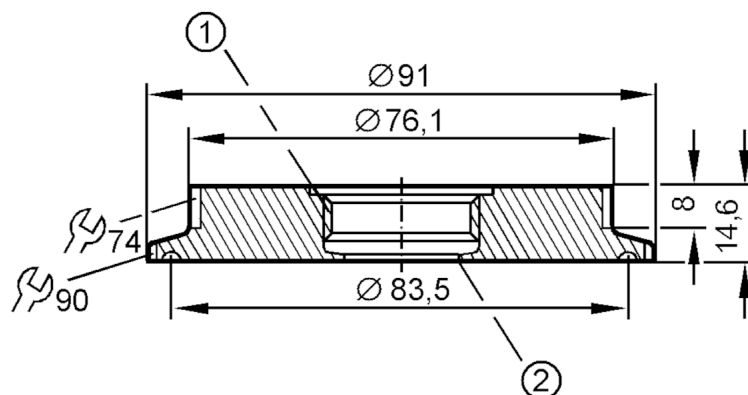

## Process adapter Tri-Clamp

ADAPT IFM-CLAMP ISO2852/3

Article to be discontinued



- 1 Aseptoflex thread  
2 Aseptoflex sealing edge

EC 1935/2004 FDA

## Application

Pressure rating [bar] 10

## Tests / approvals

Pressure equipment directive A possible classification to PED depends on the application and has to be carried out by the user / operator.

Safety instructions The compatibility between medium and product material has to be checked in all applications.

## Mechanical data

Weight [g]	554.4
Material	stainless steel (1.4404 / 316L)
Sensor connection	Aseptoflex
Process connection	Clamp DN65 (3") DIN 32676 (ISO 2852)
Surface characteristics Ra/Rz of the wetted parts	0.4 / 4
Hygienic equipment class to DIN 11866	H4

## Remarks

Pack quantity 1 pcs.