

E30135

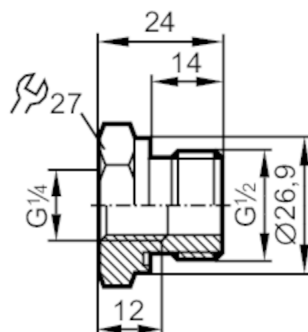

Screw-in adapter for process sensors

ADAPT G1/4 I - G1/2 A



Application

Pressure rating [bar] 400

Tests / approvals

Pressure equipment directive	A possible classification to PED depends on the application and has to be carried out by the user / operator.
Safety instructions	The compatibility between medium and product material has to be checked in all applications.

Mechanical data

Weight [g]	61.8
Material	stainless steel (1.4571/316Ti); sealing: FKM
Sensor connection	G 1/4 external thread
Process connection	threaded connection G 1/2

Remarks

Pack quantity	1 pcs.
---------------	--------