

E30013

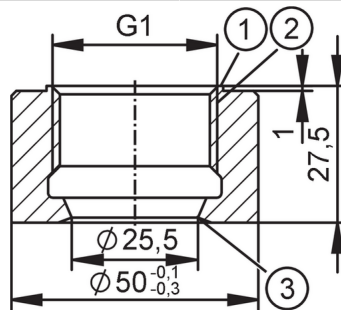

Welding adapter for process sensors

WELDING ADAPT G1 V4A



- 1 sealing area
- 2 G1 Internal thread
- 3 Sealing edge

CRN EC 1935/2004 FCM



Application

Pressure rating	150 bar	15 MPa
Note on pressure rating	for the connection sensor - adapter	
MAWP (for applications according to CRN) [bar]	150	

Tests / approvals

Pressure equipment directive	A possible classification to PED depends on the application and has to be carried out by the user / operator.
Safety instructions	The compatibility between medium and product material has to be checked in all applications.

Mechanical data

Weight [g]	300
Materials (wetted parts)	stainless steel (1.4404 / 316L) surface characteristics: Ra < 0,4 µm / Rz = 4 µm
Sensor connection	G 1 sealing cone - 27 mm
Process connection	Welding adapter Ø 50 mm

Remarks

Pack quantity	1 pcs.
---------------	--------