

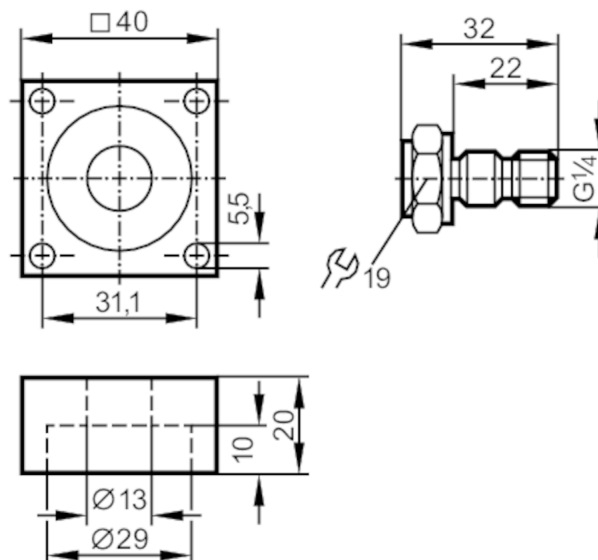

Flange adapter for process sensors

FLSH ADAPT PX 31,1



Application

Pressure rating [bar] 200

Tests / approvals

| | |
|------------------------------|---|
| Pressure equipment directive | A possible classification to PED depends on the application and has to be carried out by the user / operator. |
| Safety instructions | The compatibility between medium and product material has to be checked in all applications. |

Mechanical data

| | |
|--------------------|---|
| Weight [g] | 119 |
| Material | sealing: NBR; flange: aluminum; hollow screw: brass |
| Sensor connection | G 1/4 |
| Process connection | flange |

Remarks

| | |
|---------------|--------|
| Pack quantity | 1 pcs. |
|---------------|--------|