

E30521

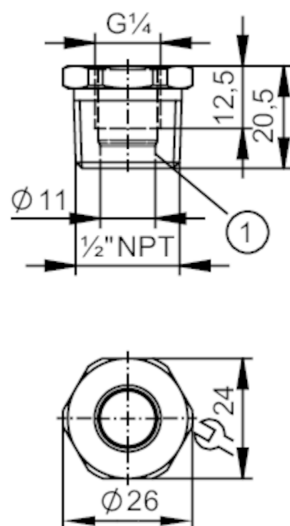

Screw-in adapter for process sensors

ADAPT G1/4 / 1/2NPT



1 sealing area

Application

Pressure rating [bar] 400

Tests / approvals

Pressure equipment directive	A possible classification to PED depends on the application and has to be carried out by the user / operator.
Safety instructions	The compatibility between medium and product material has to be checked in all applications.

Mechanical data

Weight [g]	75.7
Material	stainless steel (1.4404 / 316L)
Sensor connection	threaded connection G 1/4
Process connection	threaded connection 1/2" NPT

Remarks

Pack quantity	1 pcs.
---------------	--------