

E30498

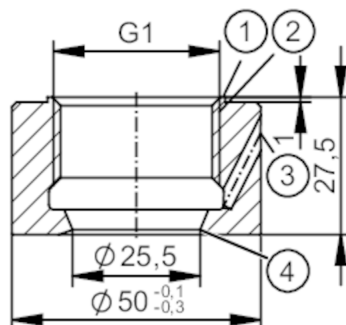

Welding adapter for process sensors

WELDING ADAPT G1 V4A



- 1 G1 Internal thread Aseptoflex Vario
- 2 Leakage port
- 3 sealing area

EHEDG Certified

Application		
Design		with leakage port (3A)
Pressure rating	[bar]	16
Note on pressure rating		for the connection sensor - adapter
Tests / approvals		
Pressure equipment directive		A possible classification to PED depends on the application and has to be carried out by the user / operator.
Safety instructions		The compatibility between medium and product material has to be checked in all applications.
Mechanical data		
Weight	[g]	312.8
Material		stainless steel (1.4435 / 316L)
Sensor connection		G 1 sealing cone
Process connection		Welding adapter Ø 50 mm
Surface characteristics Ra/Rz of the wetted parts		0.4 / 4
Remarks		
Pack quantity		1 pcs.