

E21239

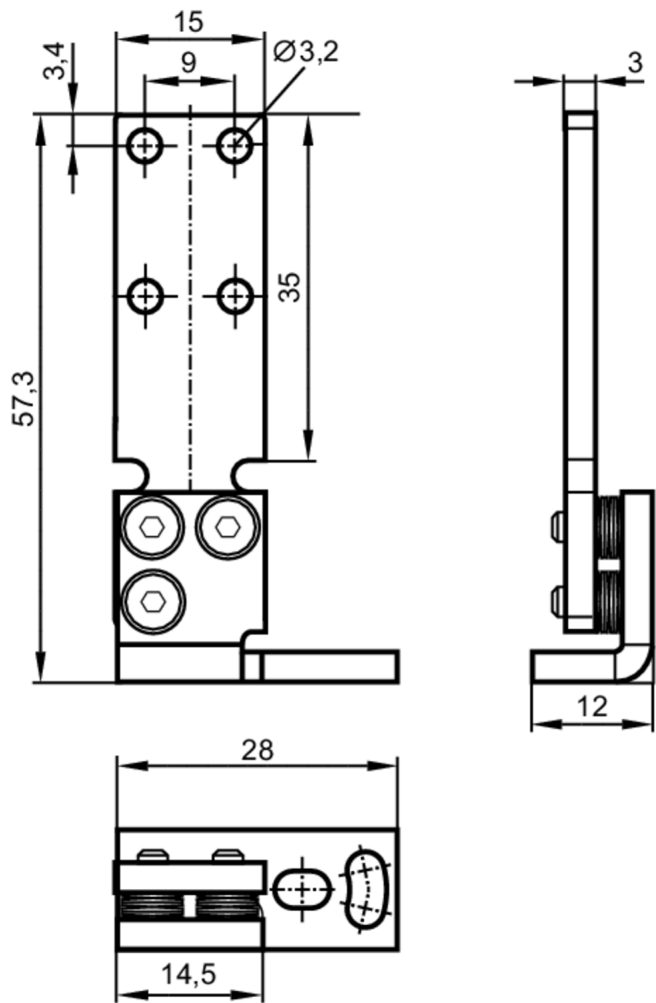

Mounting and fine adjustment bracket

FIXTURE FOR FINE ADJUSTMENT



Application

Installation

Free-standing mounting; (with fine adjustment)

Mechanical data

Weight

[g]

38.5

Type of mounting

free-standing

Dimensions

[mm]

57.3 x 12 x 28

Material

fixture: stainless steel; Spring: spring steel; screws: stainless steel

Accessories

Items supplied

screws: 2

Remarks

Pack quantity

1 pcs.