

E21224

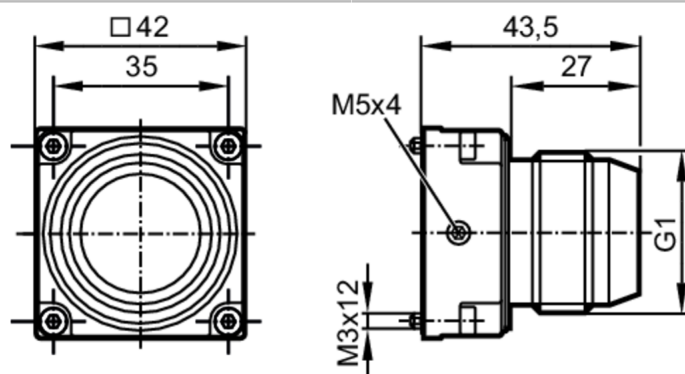

Mounting adapter for photoelectric level sensors

FLANGE ADAPTER G1 FOR O1D



Application

Design	for optical distance sensors
--------	------------------------------

Mechanical data

Weight	[g]	231
Dimensions	[mm]	42 x 43.5 x 42
Material		flange: stainless steel (1.4404 / 316L); sealing: FKM; Protective cover: PMMA transparent; screws: stainless steel; washers: stainless steel
Tightening torque	[Nm]	0.6; (screws)

Accessories

Items supplied	cylinder screws: 4 washers: 4
----------------	----------------------------------

Remarks

Pack quantity	1 pcs.
---------------	--------