

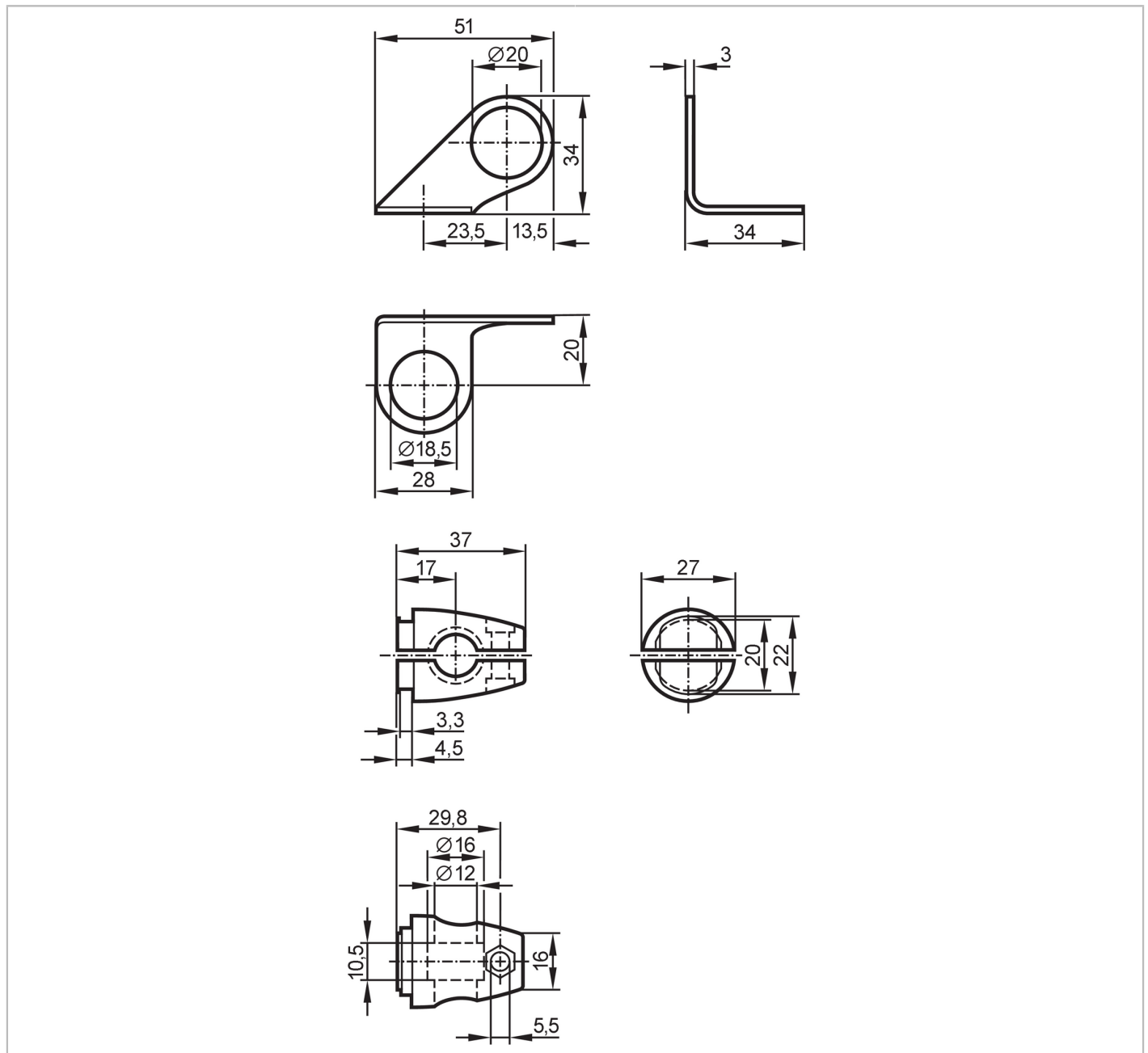

## Mounting set for position sensors

SYSTEM COMPONENT M18 BOLT



Application	
Design	Clamp mounting, for types, M18
Mechanical data	
Weight [g]	187.5
Type of mounting	free-standing; (M10)
Dimensions [mm]	$\varnothing 18.5$
Material	fixture: stainless steel (1.4571/316Ti); Clamp: stainless steel (1.4408); screw: stainless steel; washers: stainless steel; Nuts: stainless steel
Accessories	
Items supplied	head cap screw: 1 x (M10 x 55 mm) washers: 2 x ( $\varnothing 10,5$ mm) Nuts: 2 x (M10)

# E20869



## Mounting set for position sensors

SYSTEM COMPONENT M18 BOLT

Remarks	
Pack quantity	1 pcs.