

E20860

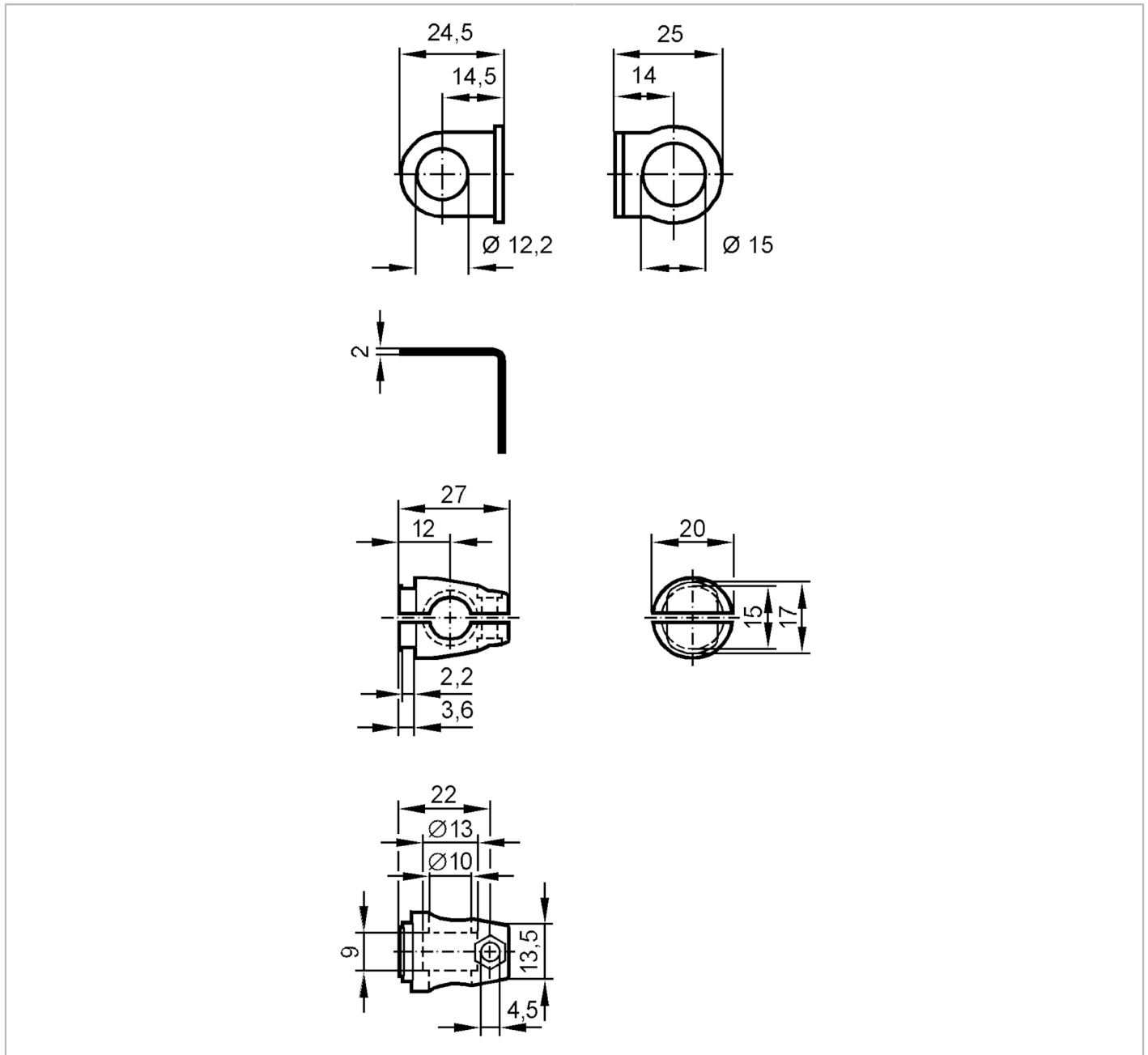

Mounting set for position sensors

SYSTEM COMPONENT M12 BOLT



Application	
Design	Clamp mounting, for types, M12
Mechanical data	
Weight [g]	81.5
Type of mounting	free-standing; (M8)
Dimensions [mm]	Ø 12.2
Material	fixture: stainless steel (1.4571/316Ti); Clamp: diecast zinc
Accessories	
Items supplied	screw: 1 x (M8 x 40 mm)
Remarks	
Pack quantity	1 pcs.