

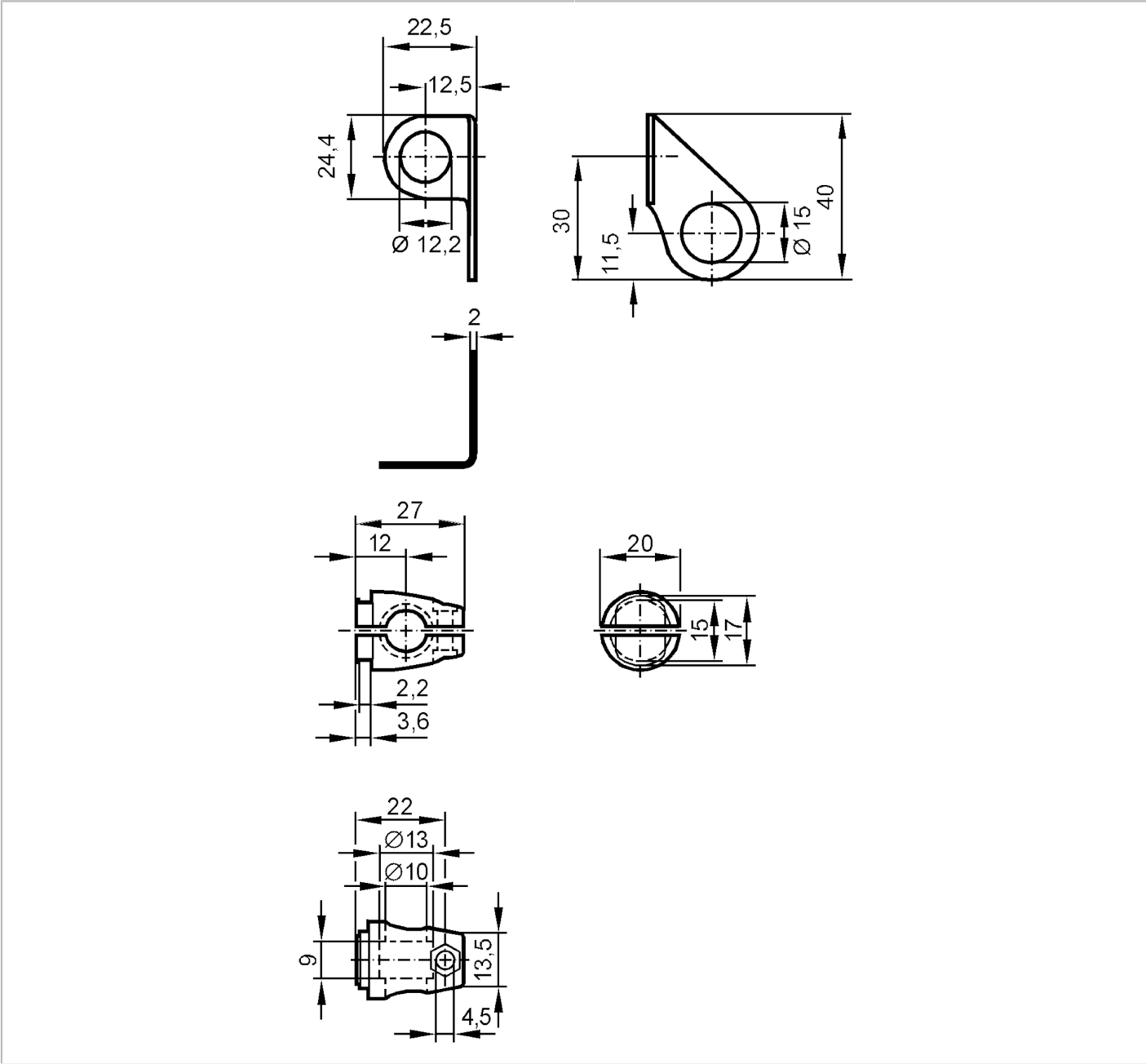

Mounting set for position sensors

SYSTEM COMPONENT M12 ROD

Article no longer available - archive entry



Mechanical data	
Type of mounting	Mounting rod; (Ø 10 mm)
Dimensions [mm]	Ø 12.2
Material	fixture: stainless steel (1.4571/316Ti); Clamp: stainless steel (1.4408)
Remarks	
Pack quantity	1 pcs.