

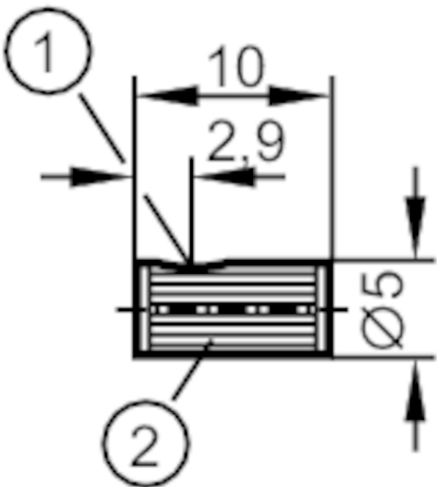

Lens attachment for fiber optics

LENS ATTACHMENT D5X10-M3



- 1 Sensing surface
- 2 Internal thread M3

Application	
Design	for through-beam fiber optics M3
Operating conditions	
Ambient temperature	[°C] -40...70
Mechanical data	
Weight	[g] 3
Material	aluminum black anodized
Remarks	
Pack quantity	2 pcs.