

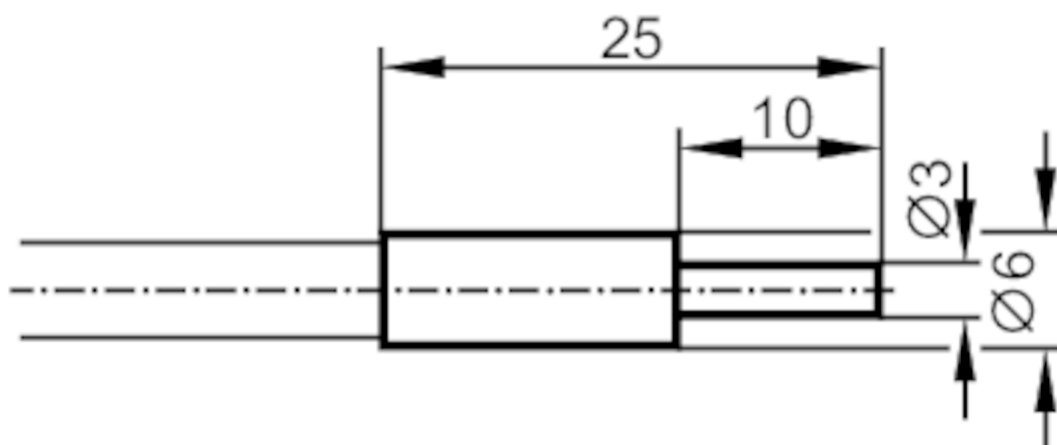

Fiber optic through beam sensor

FE-00-M-V-E3



Application

Function principle	Through-beam sensor
Application	High temperature resistance; Robust design for use in harsh industrial environments; Resistant to various aggressive chemicals

Monitoring range

Range with fiber optic amplifier type	OCF; OKF; OOF; OUF
OCF (High Power)	
Range of fiber optics [mm]	1200
OKF	
Range of fiber optics [mm]	120
OOF	
Range of fiber optics [mm]	400
OUF	
Range of fiber optics [mm]	120

Operating conditions

Ambient temperature [°C]	-20...150
--------------------------	-----------

Mechanical data

Weight [g]	95.5
Version of sensing head	straight
Sensing head diameter [mm]	3

E20492



Fiber optic through beam sensor

FE-00-M-V-E3

Sensing head length	[mm]	10
Total length	[mm]	600
Min. bending radius	[mm]	20
Fiber arrangement		
Fiber material		glass
Fiber head material		stainless steel (1.4305 / 303)
Fiber sheath material		metal silicone
Accessories		
Items supplied		E20103
Remarks		
Pack quantity		1 pcs.