

E12744

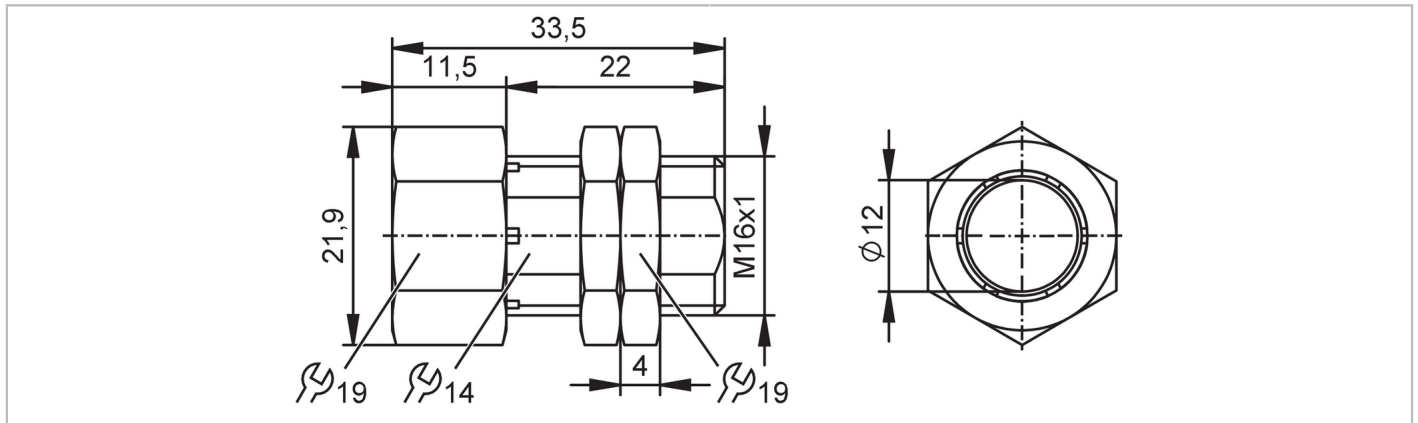

Mounting sleeve with end stop

FIXING/M12/NT/MS/END STOP



Application

Design	with end stop
--------	---------------

Mechanical data

Weight [g]	36.7
Installation instruction	Align the sensing face of the sensor to the right (see scale drawing); due to the material brass, negative sensing range reductions may occur (reduced sensing range)
Dimensions [mm]	M16 x 1 / L = 33.5
Thread designation	M16 x 1
Inside diameter [mm]	12
Material	Mounting sleeve: brass white bronze coated; Nuts: brass white bronze coated
Tightening torque [Nm]	5; (lock nuts: 20)

Accessories

Items supplied	Nuts: 2
----------------	---------

Remarks

Pack quantity	1 pcs.
---------------	--------

Diagrams and graphs

