

E12470

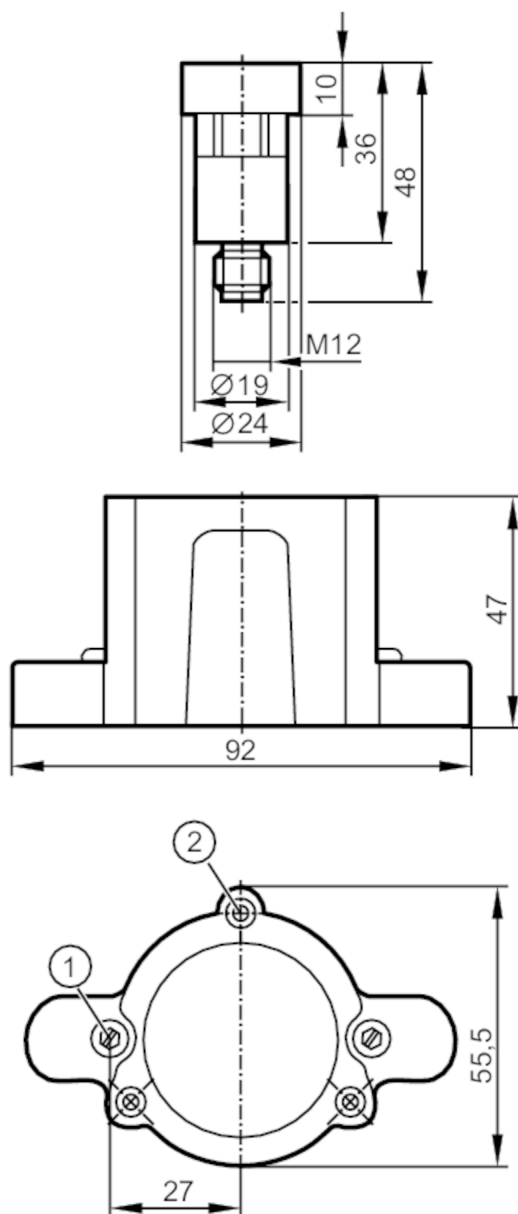

Mounting adapter for position sensors used on rising stem valves

VALVIS ADAPTER 17



- 1 head cap screw M4 to fix the adapter on the valve
2 threaded hole M4 to fix the valve sensor on the adapter

Application

Design for Alfa Laval valves Typ SSV (Single Seat Valves)

Mechanical data

Weight [g] 182.5

Material Adapter: PA 6; Target: stainless steel (1.4404 / 316L); screws: stainless steel (1.4301 / 304); Clamp: stainless steel (1.4301 / 304)

Remarks

Pack quantity 1 pcs.