

# E11027

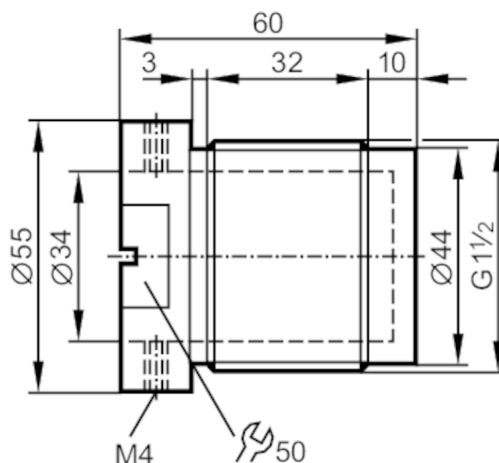

## Mounting adapter for capacitive sensors

MOUNTING ADAPTER D34MM POM



Application		
Pressure rating	[bar]	8
Operating conditions		
Ambient temperature	[°C]	-25...80
Mechanical data		
Weight	[g]	83.7
Dimensions	[mm]	G 1 1/2 / L = 60
Thread designation		G 1 1/2
Material		Adapter: POM
Sensor connection		Clamp fitting Ø 34 mm
Process connection		threaded connection G 1 1/2 external thread
Remarks		
Pack quantity		1 pcs.