

E11895

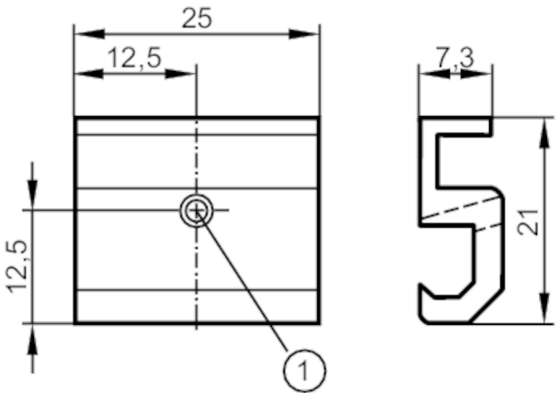

Mounting adapter for Festo pneumatic cylinders

ADAPT FOR CYL FESTO DZH



1 Mounting screw SW 1.5

Application	
Design	for types MKT
Mechanical data	
Weight [g]	8
Type of mounting	fixing: socket head screw M3; for series: Festo DZH
Dimensions [mm]	21 x 25 x 7.3
Material	Adapter: aluminum; screw: stainless steel
Remarks	
Pack quantity	1 pcs.