

E10356



Female cordset

ADOAH040MSN0005A04

Article no longer available - archive entry

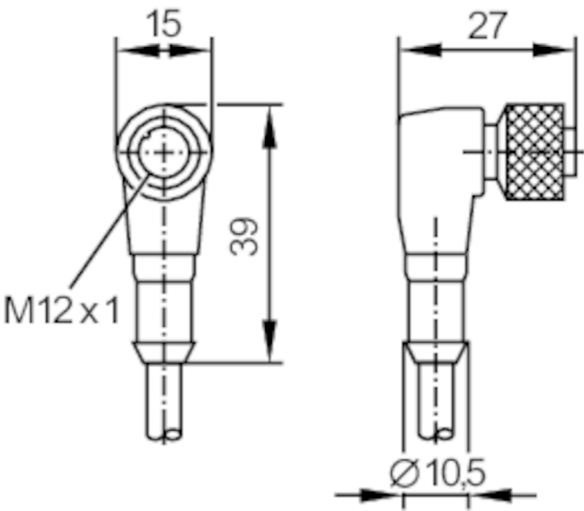

| Application | |
|--------------------------------|---|
| Application | Ex zone 1 |
| Electrical data | |
| Operating voltage [V] | < 15 DC |
| Operating conditions | |
| Ambient temperature [°C] | -25...90 |
| Protection | IP 67 |
| Safety classification | |
| Max. internal capacitance [nF] | 0.49 |
| Max. internal inductance [µH] | 10 |
| Mechanical data | |
| Dimensions [mm] | 27 x 15 x 39 |
| Material | TPU (urethane) |
| Molded-body material | TPU (urethane) |
| Material nut | brass, nickel-plated |
| Remarks | |
| Remarks | When using sockets in hazardous areas (ATEX) there are special requirements regarding wiring. The requirements of the applicable installation regulations must be absolutely adhered to by the user on his own responsibility. |
| Pack quantity | 1 pcs. |

E10356



Female cordset

ADOAH040MSN0005A04

Electrical connection

Cable: 5 m, PUR / PVC, blue, Ø 5 mm; 4 x 0.34 mm² (42 x Ø 0.1 mm)

Electrical connection - Socket

Connector: 1 x M12, angled; coding: A; Moulded body: TPU (urethane); Locking: brass, nickel-plated; Tightening torque: 0.5 Nm

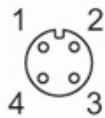

Connection

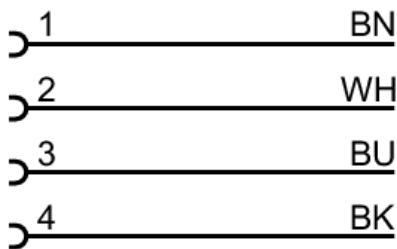

| | |
|------|---------------|
| BK = | Core colors : |
| BN = | black |
| BU = | brown |
| WH = | blue |
| | white |