

E10743



Mounting sleeve with end stop

FIXING/M30/BASIC/MS/END STOP

Article to be discontinued
Discontinuation date: 09/30/2024

Alternative articles: E12747

When selecting an alternative article and accessories please note that technical data may differ!

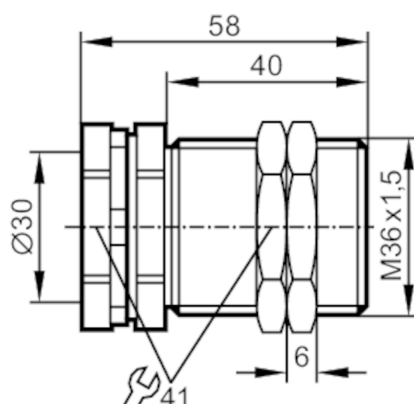

Application

Design with end stop

Mechanical data

Weight	[g]	192.7
Installation instruction	Align the sensing face of the sensor to the right (see scale drawing)	
Dimensions	[mm]	M36 x 1.5 / L = 58
Thread designation		M36 x 1.5
Inside diameter	[mm]	30
Material	brass white bronze coated; Nuts: brass white bronze coated	
Tightening torque	[Nm]	20; (lock nuts: 40)

Accessories

Items supplied Nuts: 2

Remarks

Pack quantity 1 pcs.