

# DI602A

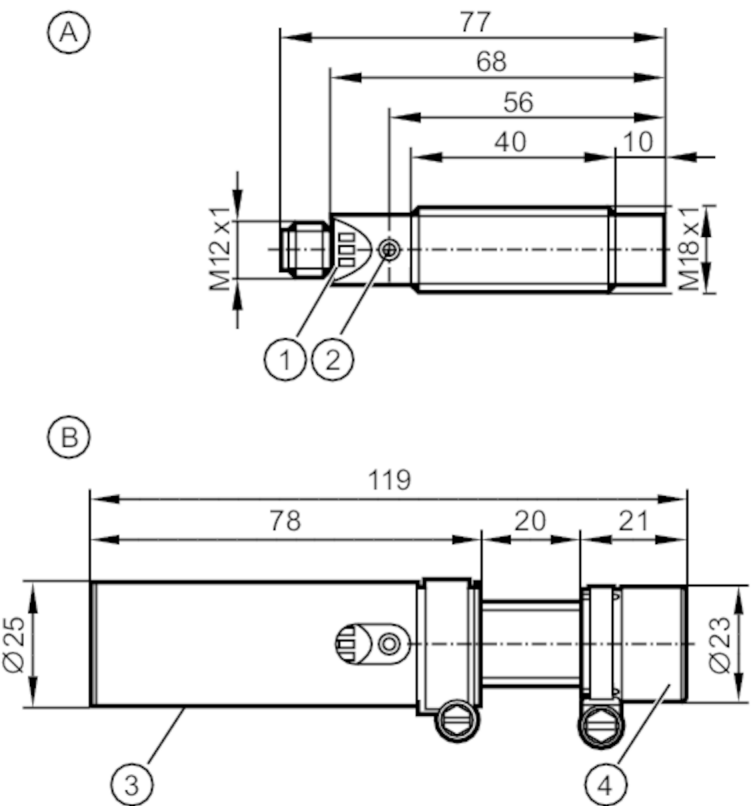

## Compact evaluation unit for speed monitoring

DGA4012-WPKG/US/3D



- A sensor  
B sensor with impact protection housing  
1 LED 3 x  
2 setting pushbutton  
3 impact protection housing for the connector  
4 impact protection housing for the sensor



### Product characteristics

Electrical design	PNP
Output function	normally open / closed; (configurable)
Sensing range [mm]	8
Dimensions [mm]	M18 x 1 / L = 68

### Application

System	gold-plated contacts
Application	evaluation of rotating and linear movements with regard to underspeed; blocking

### Electrical data

Nominal voltage DC [V]	10...36
Current consumption [mA]	< 15
Protection class	II
Reverse polarity protection	yes

### Outputs

Electrical design	PNP
Output function	normally open / closed; (configurable)

# DI602A



## Compact evaluation unit for speed monitoring

DGA4012-WPKG/US/3D

Max. voltage drop switching output DC	[V]	2.5
Permanent current rating of switching output DC	[mA]	150; (when used outside the hazardous area: 250; Pulse output: 15)
Short-circuit protection		yes
Type of short-circuit protection		yes (non-latching)
Overload protection		yes
<b>Monitoring range</b>		
Sensing range	[mm]	8
Sensing range adjustable		no
Operating distance	[mm]	0...6
<b>Measuring/setting range</b>		
Setting range	[Imp/min]	3...6000
Measuring principle		inductive
<b>Accuracy / deviations</b>		
Correction factor		steel: 1 / stainless steel: 0.7 / brass: 0.5 / aluminum: 0.4 / copper: 0.3
Hysteresis	[% of Sr]	10
<b>Reaction times</b>		
Start-up delay	[s]	0...15
Max. damping frequency	[Imp/min]	18000
<b>Software / programming</b>		
Adjustment of the switch point		Teach function
<b>Operating conditions</b>		
Ambient temperature	[°C]	-20...50
Note on ambient temperature		when used outside the hazardous area: -20...60 °C
Storage temperature	[°C]	-25...60
Protection		IP 67
<b>Tests / approvals</b>		
ATEX marking		 II 3D Ex tc IIIC T80°C Dc IP67 U
Note on ATEX marking		only in conjunction with the impact protective housing
EMC		EN 60947-5-2
MTTF	[years]	1051
<b>Mechanical data</b>		
Weight	[g]	177
Mounting		non-flush mountable
Dimensions	[mm]	M18 x 1 / L = 68
Thread designation		M18 x 1
Material		stainless steel (1.4571/316Ti ); PBT; TPE-U
<b>Displays / operating elements</b>		
Display	Switching status	1 x LED, yellow
	Power	1 x LED, green
	input signal	1 x LED, green

# DI602A



## Compact evaluation unit for speed monitoring

DGA4012-WPKG/US/3D

Accessories	
Items supplied	lock nuts: 2
	impact protection housing
	Mounting clamp

### Electrical connection - plug

Connector: 1 x M12; coding: A; Contacts: gold-plated



### Connection

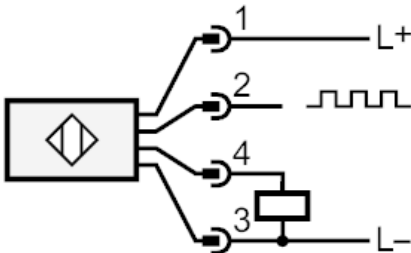

- 1: L+
- 2: Pulse output pulse sequence corresponds to damping frequency
- 3: L-
- 4: Switching output adjustable