

DF2101

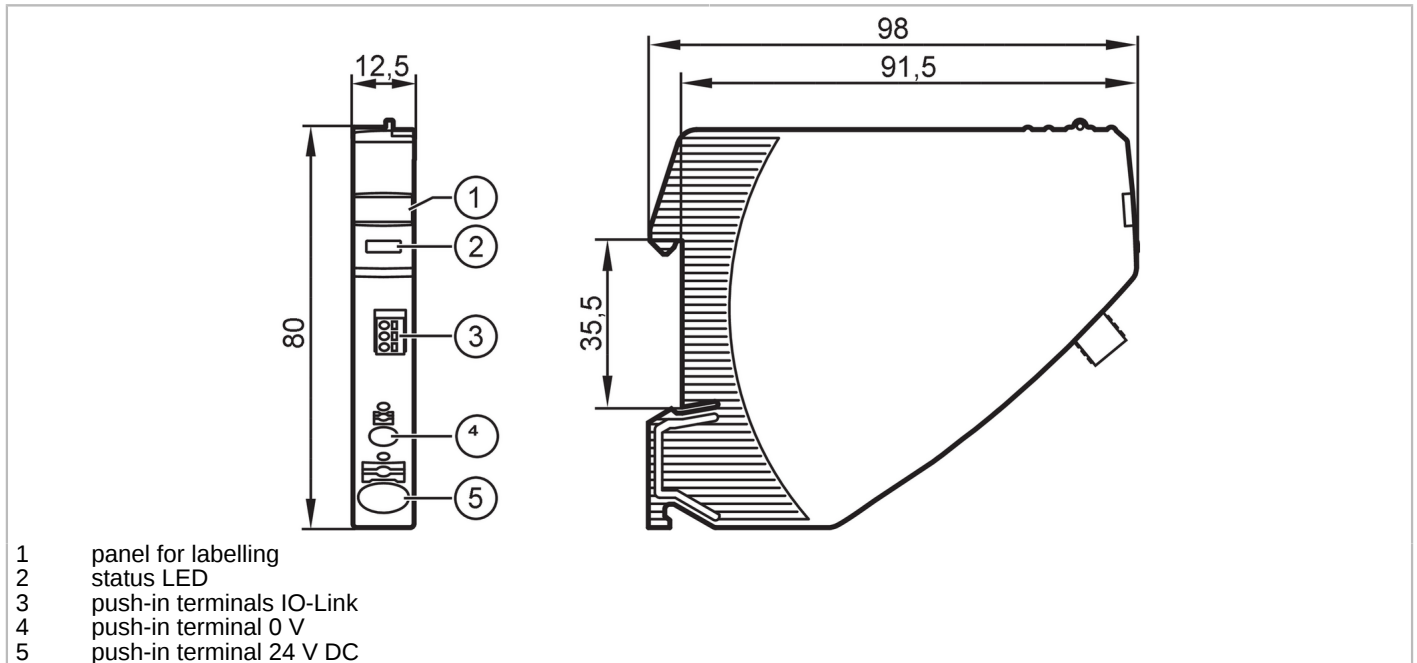

Power supply module for electronic circuit breaker

Fuse/IO-Link/24VDC/Module



- 1 panel for labelling
- 2 status LED
- 3 push-in terminals IO-Link
- 4 push-in terminal 0 V
- 5 push-in terminal 24 V DC



Application							
Design	housing for DIN rail mounting						
Electrical data							
Operating voltage [V]	to SELV/PELV						
Nominal voltage DC [V]	24						
Input voltage DC [V]	19.2...30						
Protection class	III						
Reverse polarity protection	yes						
Mains buffering time (nominal voltage 24 V DC) [ms]	10						
Input current (nominal voltage 24 V DC) [A]	40						
Closed-circuit current [mA]	10						
Power loss (nominal voltage 24 V DC) [W]	0.48						
Interfaces							
Communication interface	IO-Link						
Transmission type	COM2 (38,4 kBaud)						
IO-Link revision	1.1						
SIO mode	no						
Min. process cycle time [ms]	20						
Supported DeviceIDs	<table border="1" style="width: 100%; border-collapse: collapse;"> <thead> <tr style="background-color: #333; color: white;"> <th>Type of operation</th> <th>DeviceID</th> </tr> </thead> <tbody> <tr> <td>Default</td> <td>892</td> </tr> <tr> <td>Status B</td> <td>1573</td> </tr> </tbody> </table>	Type of operation	DeviceID	Default	892	Status B	1573
Type of operation	DeviceID						
Default	892						
Status B	1573						
Note	For further information please see the IODD PDF file at "Downloads"						
Operating conditions							
Ambient temperature [°C]	-25...60						

DF2101



Power supply module for electronic circuit breaker

Fuse/IO-Link/24VDC/Module

Storage temperature	[°C]	-40...70
Protection		IP 20; (on the front)
Degree of soiling		2

Tests / approvals		
EMC	EN 61000-6-3	radiation of interference
	EN 61000-6-2	noise immunity

Mechanical data		
Weight	[g]	73
Housing		rectangular
Type of mounting		Mounting on DIN rail; (TH35 (EN 60715))
Dimensions	[mm]	80 x 12.5 x 98

Displays / operating elements		
Display	status	1 x LED, red / green / orange

Remarks		
Pack quantity		1 pcs.

Electrical connection

push-in terminals:

contact lever/strip:

Connection

