

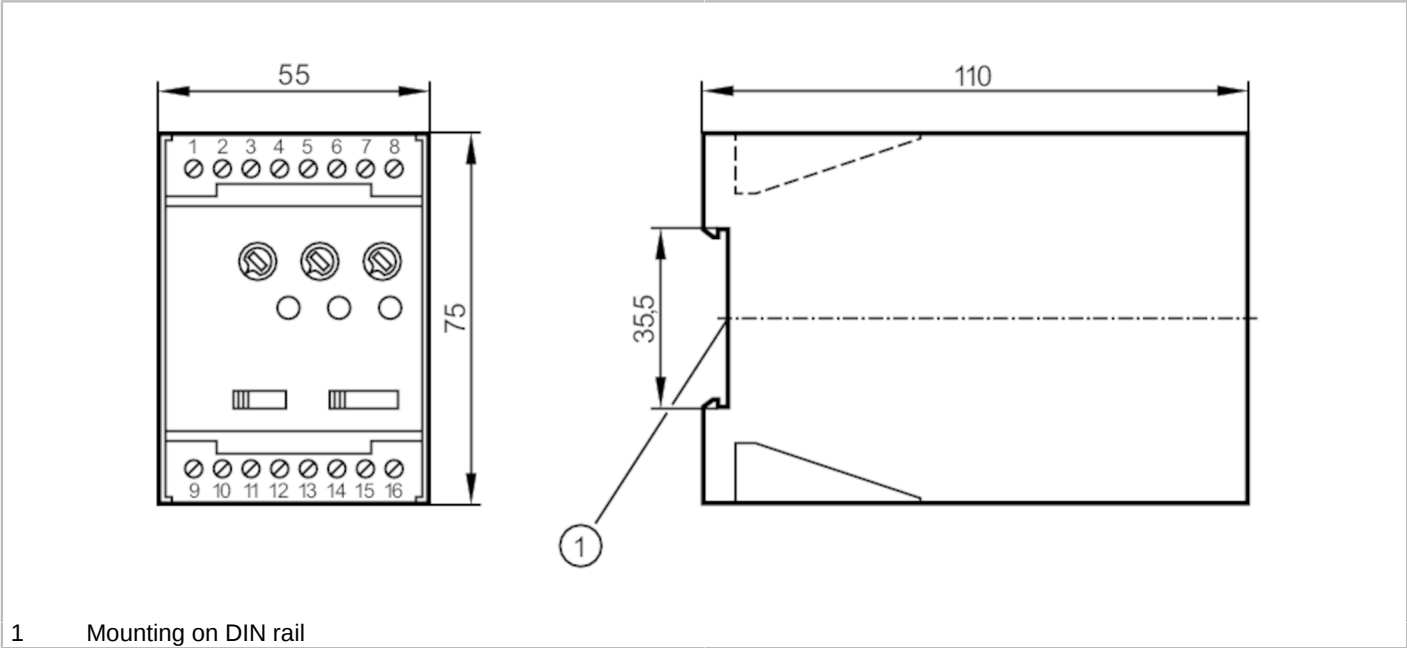

Evaluation unit for speed monitoring

D100/230VAC/WINDOW

Article no longer available - archive entry



Product characteristics		
Housing		housing for DIN rail mounting
Dimensions	[mm]	75 x 55 x 110
Application		
Application		universal evaluation of pulse sequences with regard to overspeed and underspeed; Rotational speed monitoring
Electrical data		
Nominal voltage AC	[V]	< 230
Nominal voltage DC	[V]	24
Nominal voltage tolerance	[%]	10
Nominal voltage tolerance 2	[%]	10
Nominal frequency AC	[Hz]	50...60
Auxiliary energy for sensors DC	[V]	24; (≤ 30 mA)
Inputs / outputs		
Number of inputs and outputs		Number of relay outputs: 2
Outputs		
Number of relay outputs		2
Contact rating		17 V DC / 10 mA ...24 V DC / 200 mA
Measuring/setting range		
Setting range	[Imp/min]	20...200
Accuracy / deviations		
Hysteresis	[% of Sr]	> 5
Note on hysteresis		fixed



Evaluation unit for speed monitoring

D100/230VAC/WINDOW

Repeatability	[% of Sr]	1
Reaction times		
Start-up delay	[s]	0.5...15
Software / programming		
Adjustment of the switch point	fine adjustment within the range with potentiometer	
Operating conditions		
Ambient temperature	[°C]	-20...70
Protection	IP 40	
Protection rating terminals	IP 20	
Mechanical data		
Housing	housing for DIN rail mounting	
Dimensions	[mm]	75 x 55 x 110
Material	plastics	
Displays / operating elements		
Display	input signal	1 x LED, yellow
	Switching status	1 x LED, red
Electrical connection		
Connection		