

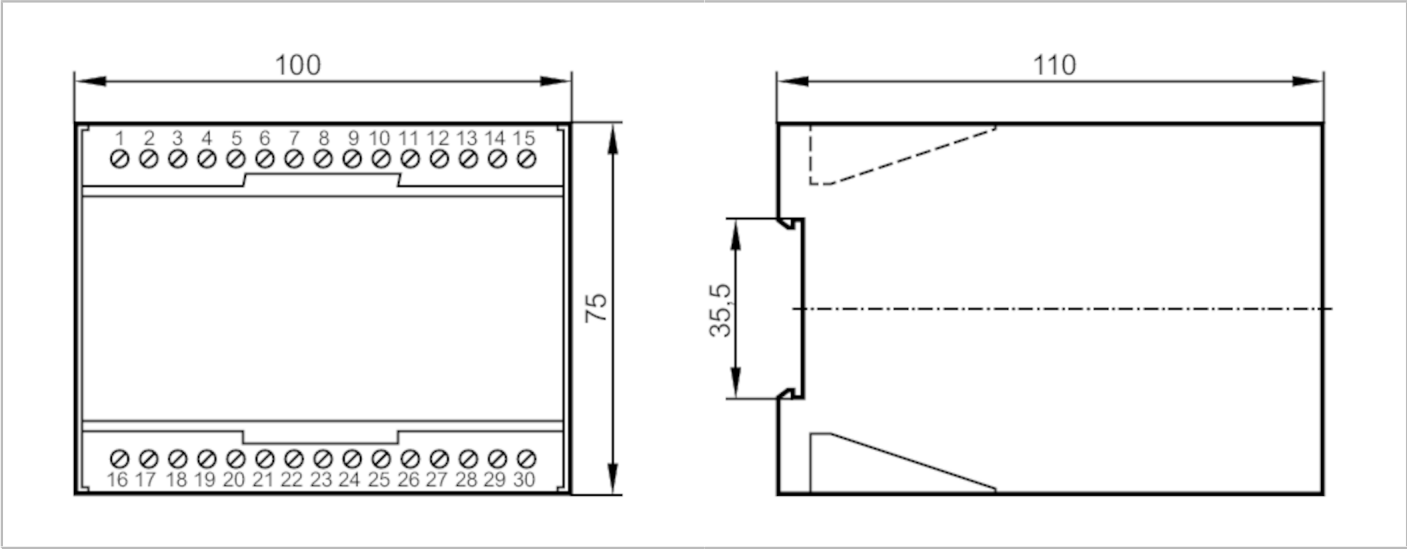

Evaluation unit for skew monitoring

C230/230VAC

Article no longer available - archive entry



| Product characteristics | | |
|---------------------------------|------|--|
| Housing | | housing for DIN rail mounting |
| Dimensions | [mm] | 75 x 100 x 110 |
| Application | | |
| Application | | monitoring the belt with 2 sensors each at the ends of the bucket conveyor with regard to misalignment; skew monitoring on bucket conveyors to prevent belt wear and subsequent damage |
| Electrical data | | |
| Nominal voltage AC | [V] | < 230 |
| Nominal voltage DC | [V] | 24 |
| Nominal voltage tolerance | [%] | 10 |
| Nominal voltage tolerance 2 | [%] | 10 |
| Nominal frequency AC | [Hz] | 47...63 |
| Auxiliary energy for sensors DC | [V] | 24 |
| Inputs / outputs | | |
| Number of inputs and outputs | | Number of relay outputs: 2 |
| Outputs | | |
| Number of relay outputs | | 2 |
| Contact rating | | 6 A / 1000 VA / 250 V AC |
| Software / programming | | |
| Adjustment of the switch point | | potentiometer |
| Operating conditions | | |
| Ambient temperature | [°C] | 0...50 |
| Protection | | IP 40 |
| Protection rating terminals | | IP 20 |



Evaluation unit for skew monitoring

C230/230VAC

| Mechanical data | | |
|-----------------|------|-------------------------------|
| Weight | [g] | 624 |
| Housing | | housing for DIN rail mounting |
| Dimensions | [mm] | 75 x 100 x 110 |
| Material | | plastics |

| Displays / operating elements | | |
|-------------------------------|------------------|----------------|
| Display | Switching status | 2 x LED, red |
| | input signal | 4 x LED, green |
| | fault | 4 x LED, red |

| Electrical connection | |
|-----------------------|--|
| terminals: ...2.5 mm² | |
| Connection | |

