

AC5101

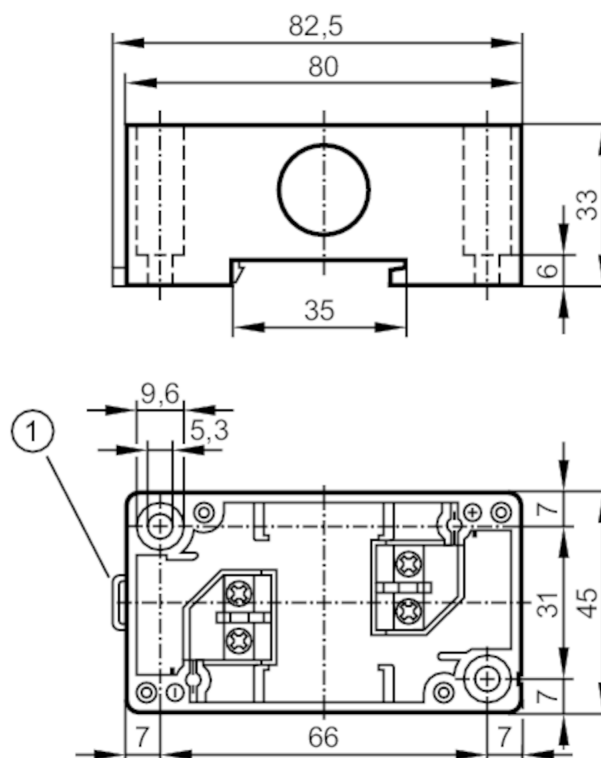

Lower part for AS-Interface module

EMS-BASE RC ST



1 locking bolt

Electrical data

Operating voltage	[V]	26.5...31.6 DC
-------------------	-----	----------------

Outputs

Electrical design	AS-i
Contact rating	< 4 A

Operating conditions

Ambient temperature	[°C]	-25...85
Protection		IP 65

Mechanical data

Weight	[g]	70.5
Type of mounting		Mounting on DIN rail and panel
Dimensions	[mm]	45 x 82.5 x 33
Material		PBT

Accessories

Accessories (optional)	cover:, for AS-i module, AC3000 screw terminal insert:, AC5007
------------------------	---

Remarks

Remarks	up to 4 M20 cable ports for any T and cross branches For DIN rail mounting pull the locking bolt outwards using a suitable tool (e.g. screwdriver).
Pack quantity	1 pcs.

Electrical connection

screw terminals: ...2.5 mm²