

AC5001



Lower part for AS-Interface module

ASI-MODUL-UNTERTEIL PG

Article no longer available - archive entry

Alternative articles: AC5101

When selecting an alternative article and accessories please note that technical data may differ!

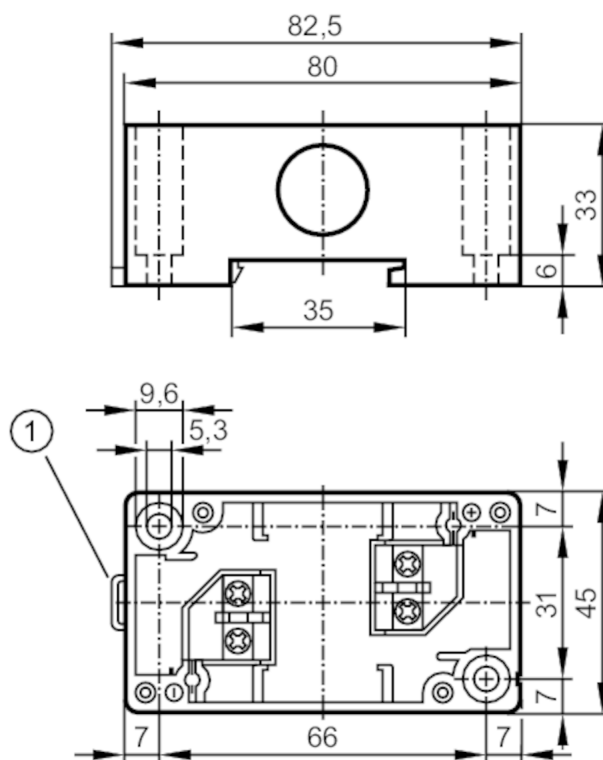

1 locking bolt

Electrical data

Operating voltage [V] 26.5...31.6 DC

Outputs

Electrical design AS-i
Contact rating < 4 A

Operating conditions

Ambient temperature [°C] -25...85
Protection IP 65

Mechanical data

Type of mounting Mounting on DIN rail and panel
Dimensions [mm] 45 x 82.5 x 33
Material PBT

Remarks

Remarks up to 4 screw connection outgoing cables for any type of T or cross branch
Pack quantity 1 pcs.

Electrical connection

screw terminals: ...2.5 mm²