

# AC2396

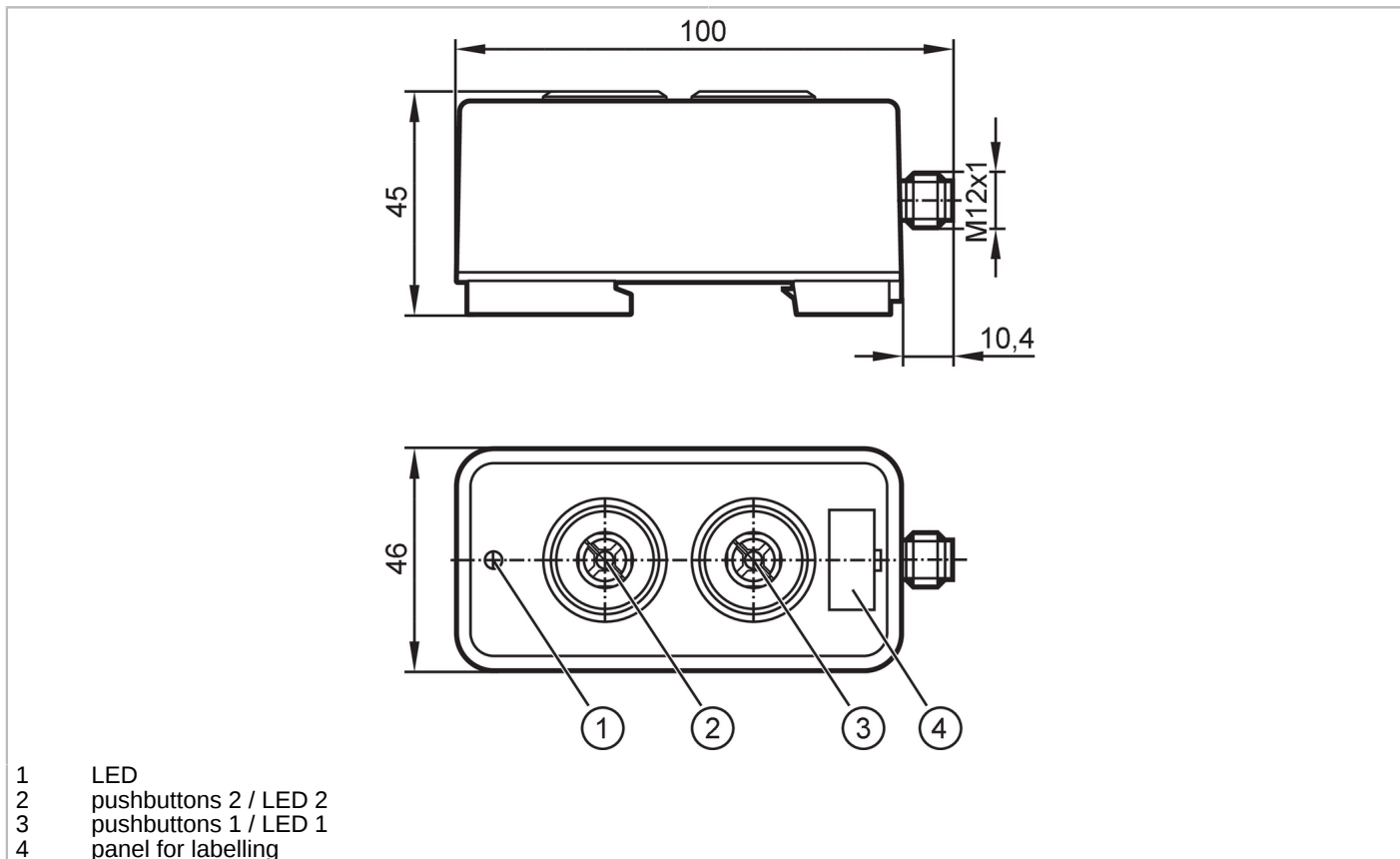

## AS-Interface illuminated pushbutton module

AS-i Module 2BI 2LO WT/WT



Application		
Design	housing for DIN rail mounting, Color inserts changeable	
Application	field installation	
Electrical data		
Operating voltage [V]	26.5...31.6 DC	
Max. current consumption from AS-i [mA]	55	
Inputs		
Sensor supply of the inputs	AS-i	
Operating conditions		
Ambient temperature [°C]	-25...60	
Storage temperature [°C]	-40...85	
Protection	IP 67	
Tests / approvals		
EMC	EN 61000-6-2	
	EN 62026-2	
UL approval	Enclosure type	Type 1
	voltage supply	Class 2
	File number UL	E205959
AS-i classification		
AS-i version	2.11; 3.0	

# AC2396



## AS-Interface illuminated pushbutton module

AS-i Module 2BI 2LO WT/WT

Extended addressing mode	yes				
AS-i master profile	M2; M3; M4				
AS-i profile	S-B.A.E				
AS-i I/O configuration [hex]	B				
AS-i ID code [hex]	A.E				
AS-i certificate	134701				
Data bits	Data bit	D0	D1	D2	D3
	LED	1	2	-	-
	pushbuttons	-	-	1	2

Mechanical data	
Weight [g]	137.6
Housing	rectangular
Type of mounting	Mounting on DIN rail; (TH35 (EN 60715))
Dimensions [mm]	100 x 46 x 45
Material	PA

Displays / operating elements		
Display	Power	LED, green
	errors	LED, red
Operating elements	2	freely programmable backlit function keys

Electrical connection	
Module connection	M12

Accessories	
Items supplied	cover support: 2
	color inserts: 2, red
	2, green
	2, yellow
	2, blue
	2, white
	Mounting adapter: 1

Remarks	
Remarks	The pushbuttons (EAO type 84) provide protection against accidental contact. Housing and pushbuttons can be labeled.
Pack quantity	1 pcs.

Electrical connection	
Connector: M12; coding: A	
1	AS-i +
3	AS-i -