

TS325A

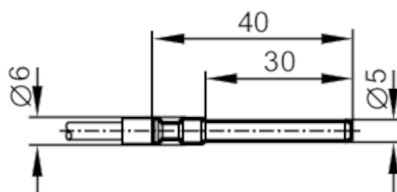

Temperature cable sensor with process connection

TS-300KEKD06...../3M/3D/3G



Product characteristics

Measuring range	-20...80 °C	-4...176 °F
Process connection	Ø 5 mm	

Application

Special feature	Screened cable	
Measuring element	1 x Pt 100; (to DIN EN 60751, class B; operating current max. 10 mA)	
Media	liquids and gases	
Minimum installation depth [mm]	15	

Electrical data

Insulation rating [V]	2500; (insulation between sensor housing and internal structure of the sensor)	
Protection class	III	

Measuring/setting range

Measuring range	-20...80 °C	-4...176 °F
Note on measuring range	measuring range for non-ATEX applications: -20...180 °C / -4...356 °F	

Accuracy / deviations

Accuracy [K]	± (0,30 K + 0,005 x t)	
--------------	-------------------------	--

Response times

Dynamic response T05 / T09 [s]	4 / 10; (to DIN EN 60751)	
--------------------------------	---------------------------	--

Operating conditions

Ambient temperature [°C]	-20...80	
Protection	IP 67	

Tests / approvals

ATEX marking	Ex II 3D Ex tc IIC T100°C Dc X	
	Ex II 3G Ex nA IIC T5 Gc X	
MTTF [ANN]	19025.9	

Mechanical data

Weight [g]	88.6	
Dimensions [mm]	Ø 5 / L = 40	
Materials	stainless steel (1.4404 / 316L)	
Materials (wetted parts)	stainless steel (1.4404 / 316L)	
Process connection	Ø 5 mm	
Probe diameter [mm]	5	

Remarks

Remarks	The values for accuracy apply to flowing water.	
---------	---	--

TS325A



Temperature cable sensor with process connection

TS-300KEKD06...../3M/3D/3G

Pack quantity

1 pcs.

Electrical connection

Cable: 3 m, silicone, shielded

Connection

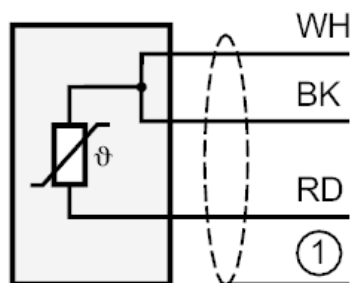

1 = screen not connected to the housing
Core colours :
WH = white
BK = black
RD = red