

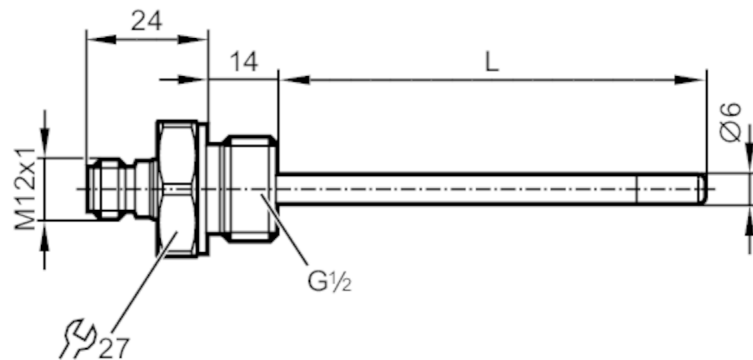

## Temperature sensor with process connection

TM-150KFBR12-

/US/



### Product characteristics

Measuring range	-40...150 °C	-40...302 °F
Process connection	threaded connection G 1/2	
Installation length EL [mm]	150	

### Application

Special feature	Gold-plated contacts	
Measuring element	1 x Pt 100; (to DIN EN 60751, class A)	
Media	liquids and gases	
Pressure rating [bar]	160	
Minimum installation depth [mm]	15	

### Electrical data

Protection class	III
------------------	-----

### Measuring/setting range

Probe length L	[mm]	136	
Measuring range		-40...150 °C	-40...302 °F

### Accuracy / deviations

Accuracy [K]	± (0,15 K + 0,002 x t )
--------------	-------------------------

### Response times

Dynamic response T05 / T09 [s]	1 / 3; (to DIN EN 60751)
--------------------------------	--------------------------

### Operating conditions

Ambient temperature [°C]	-25...80
Storage temperature [°C]	-40...100
Protection	IP 68; IP 69K

### Tests / approvals

Shock resistance	DIN EN 60068-2-27	50 g (11 ms)
Vibration resistance	DIN EN 60068-2-6	10 g (10...2000 Hz)
MTTF [ANN]	22831	

### Mechanical data

Weight [g]	183
Materials	stainless steel (1.4404 / 316L)
Materials (wetted parts)	stainless steel (1.4404 / 316L); FKM

# TM4441



## Temperature sensor with process connection

TM-150KFBR12- /US/

Tightening torque	[Nm]	45
Process connection		threaded connection G 1/2
Probe diameter	[mm]	6
Installation length EL	[mm]	150

### Remarks

Remarks	operating voltage "supply class 2" according to cULus
	The values for accuracy apply to flowing water.
Pack quantity	1 pcs.

### Electrical connection

Connector: 1 x M12; coding: A; Contacts: gold-plated



### Connection

