

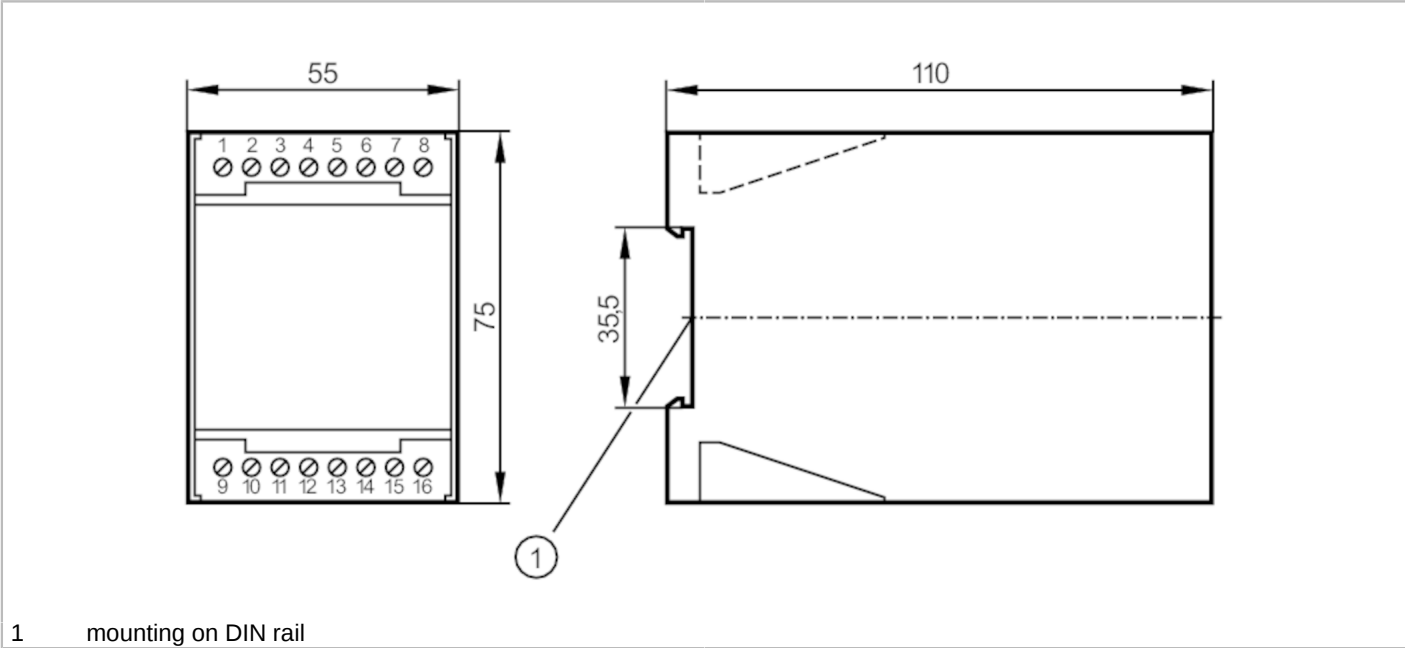

Control monitor for flow sensors

VS0100/ 24VDC

Article no longer available - archive entry



Application

Application	Flow monitoring
-------------	-----------------

Electrical data

Operating voltage tolerance	[%]	-10...10
Operating voltage	[V]	24 DC
Current consumption	[mA]	40; (24 V)
Number of channels		1

Outputs

Electrical design	relay
Switching function flow monitoring	relay energised when flow is present

Operating conditions

Ambient temperature	[°C]	-20...60
Protection		IP 40
Protection rating terminals		IP 20

Mechanical data

Housing		housing for DIN rail mounting
Dimensions	[mm]	75 x 55 x 110
Materials		plastics

Remarks

Pack quantity	1 pcs.
---------------	--------

SZ0024



Control monitor for flow sensors

VS0100/ 24VDC

Electrical connection

terminals: 16 x ...2.5 mm²

Connection

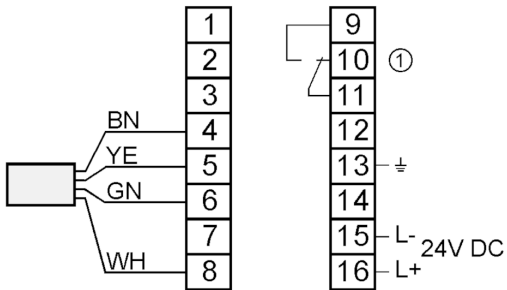

1: Relais Flow monitoring

Core colours :

BN = brown

YE = yellow

GN = green

WH = white