

ST4010



Flow sensor for connection to an evaluation unit

STN34ABA/NPT-GEW

Article no longer available - archive entry

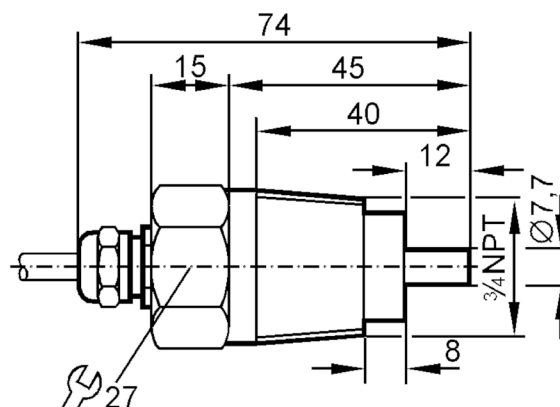

Product characteristics

Process connection	3/4" NPT
--------------------	----------

Application

Application	high-temperature range
Media	Liquids; Gases
Medium temperature [°C]	-25...80
Pressure rating [bar]	30

Liquids

Application	high-temperature range
Medium temperature [°C]	-25...80

Gases

Medium temperature [°C]	-25...80
-------------------------	----------

Electrical data

Connection to control monitor	VS 0100
-------------------------------	---------

Measuring/setting range

Liquids

Setting range [cm/s]	3...300
Greatest sensitivity [cm/s]	3...60

Gases

Setting range [cm/s]	5...1500
----------------------	----------

Accuracy / deviations

Temperature gradient [K/min]	15
------------------------------	----

ST4010



Flow sensor for connection to an evaluation unit

STN34ABA/NPT-GEW

Response times		
Response time	[s]	1...10
Liquids		
Response time	[s]	1...10
Gases		
Response time	[s]	1...10
Operating conditions		
Protection		IP 67
Mechanical data		
Housing		threaded type
Materials		stainless steel (1.4305 / 303)
Process connection		3/4" NPT
Remarks		
Pack quantity		1 pcs.
Electrical connection		
Cable: 2 m, Silflex-PUR; Maximum cable length: 100 m; 4 x 0.5 mm ²		
Connection		

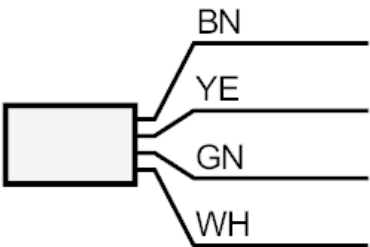

	Core colours :
BK =	black
BN =	brown
BU =	blue
WH =	white