

Flow sensor for connection to an evaluation unit

STR12ZBB/6m

Article no longer available - archive entry

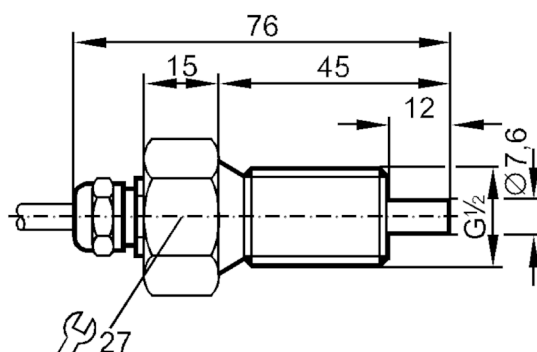

Product characteristics

Process connection	G 1/2 external thread
--------------------	-----------------------

Application

Application	high-temperature range
Media	Liquids; Gases
Pressure rating [bar]	30

Liquids

Application	high-temperature range
Medium temperature [°C]	0...120

Gases

Medium temperature [°C]	0...100
-------------------------	---------

Electrical data

Connection to control monitor	VS 0100
-------------------------------	---------

Measuring/setting range

Liquids

Setting range [cm/s]	3...300
Greatest sensitivity [cm/s]	3...60

Gases

Setting range [cm/s]	5...1500
----------------------	----------

Accuracy / deviations

Temperature gradient [K/min]	15
------------------------------	----

Response times

Response time [s]	1...10
-------------------	--------

ST3301



Flow sensor for connection to an evaluation unit

STR12ZBB/6m

Liquids		
Response time	[s]	1...10
Gases		
Response time	[s]	1...10
Operating conditions		
Protection		IP 67
Mechanical data		
Housing		threaded type
Materials		stainless steel (1.4571/316Ti)
Process connection		G 1/2 external thread
Remarks		
Pack quantity		1 pcs.
Electrical connection		
Cable: 6 m, silicone; Maximum cable length: 100 m; 4 x 0.25 mm ²		
Connection		

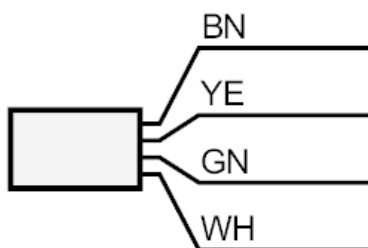

	Core colours :
BN =	brown
GN =	green
WH =	white
YE =	yellow