

# ST2200



## Flow sensor for connection to an evaluation unit

STR14ABB

Article no longer available - archive entry

Alternative articles: ST2204

When selecting an alternative article and accessories please note that technical data may differ!

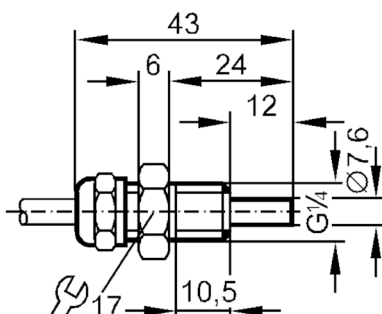

### Product characteristics

Process connection G 1/4 external thread

### Application

Application high-temperature range

Media Liquids; Gases

Medium temperature [°C] -25...80

Pressure rating [bar] 30

### Liquids

Application high-temperature range

Medium temperature [°C] -25...80

### Gases

Medium temperature [°C] -25...80

### Electrical data

Connection to control monitor VS 0100

### Measuring/setting range

#### Liquids

Setting range [cm/s] 3...300

Greatest sensitivity [cm/s] 3...60

#### Gases

Setting range [cm/s] 5...1500

### Accuracy / deviations

Temperature gradient [K/min] 15

### Response times

Response time [s] 1...10

#### Liquids

Response time [s] 1...10

#### Gases

Response time [s] 1...10

# ST2200



## Flow sensor for connection to an evaluation unit

STR14ABB

### Operating conditions

Protection	IP 67
------------	-------

### Mechanical data

Housing	threaded type
Materials	stainless steel (1.4571/316Ti )
Process connection	G 1/4 external thread

### Remarks

Pack quantity	1 pcs.
---------------	--------

### Electrical connection

Cable: 2 m, Silflex-PUR; Maximum cable length: 100 m; 4 x 0.5 mm<sup>2</sup>

#### Connection

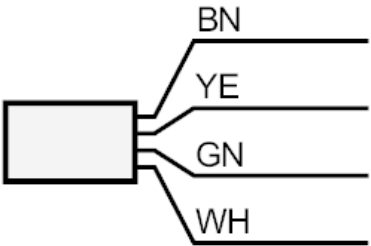

	Core colours :
BK =	black
BN =	brown
BU =	blue
WH =	white