

ST2400



Flow sensor for connection to an evaluation unit

STR14AAC

Article no longer available - archive entry

Alternative articles: ST2404

When selecting an alternative article and accessories please note that technical data may differ!

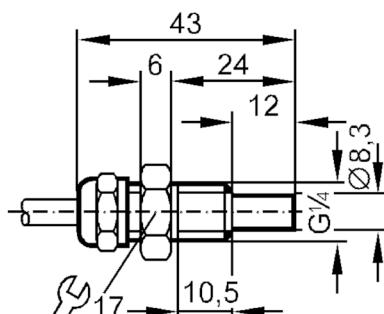

Product characteristics

Process connection G 1/4 external thread

Application

Media Liquids; aggressive media

Medium temperature [°C] -25...80

Pressure rating [bar] 5

Liquids

Medium temperature [°C] -25...80

Electrical data

Connection to control monitor VS 0100

Measuring/setting range

Liquids

Setting range [cm/s] 3...300

Greatest sensitivity [cm/s] 3...60

Accuracy / deviations

Temperature gradient [K/min] 7

Response times

Response time [s] 2...20

Liquids

Response time [s] 2...20

Operating conditions

Protection IP 67

Mechanical data

Housing threaded type

Materials PTFE

Process connection G 1/4 external thread

Remarks

Pack quantity 1 pcs.

ST2400



Flow sensor for connection to an evaluation unit

STR14AAC

Electrical connection

Cable: 2 m, Silflex-PUR; Maximum cable length: 100 m; 4 x 0.5 mm²

Connection

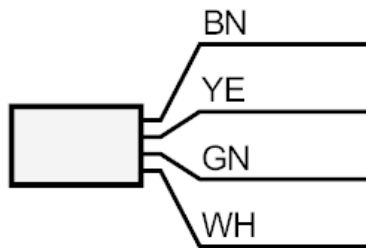

BK =	Core colours :
BN =	black
BU =	brown
WH =	blue
	white