

Article no longer available - archive entry

Alternative articles: SN0150

When selecting an alternative article and accessories please note that technical data may differ!

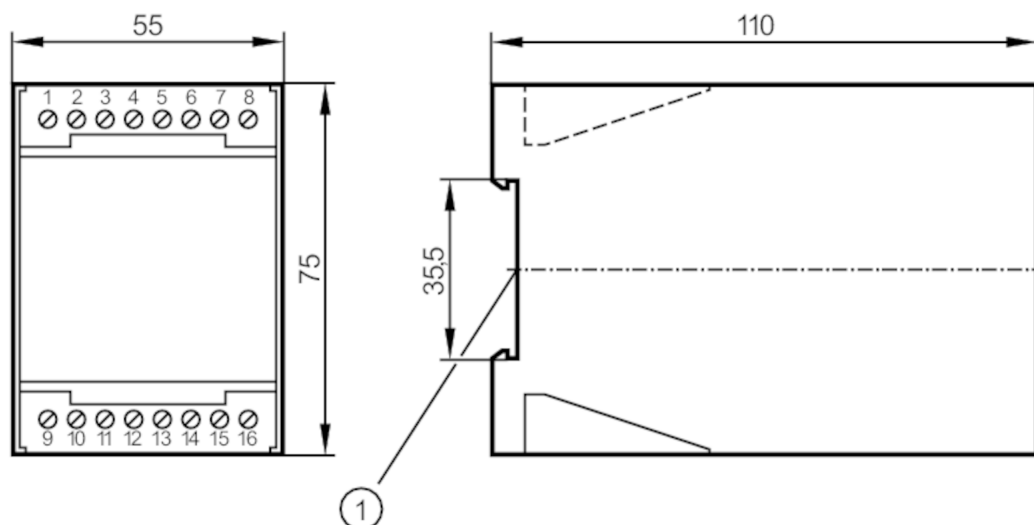

1 mounting on DIN rail



Application

Application	Flow monitoring
-------------	-----------------

Electrical data

Operating voltage	[V]	< 200 AC
Max. power consumption	[VA]	3
Power-on delay time	[s]	30
Number of channels		1

Outputs

Electrical design	relay
Contact rating	4 A, 250 V AC
Switching function flow monitoring	relay energised when flow is present

Software / programming

Adjustment of the switch point	potentiometer
--------------------------------	---------------

Operating conditions

Ambient temperature	[°C]	0...60
Protection		IP 40
Protection rating terminals		IP 20

Mechanical data

Housing	housing for DIN rail mounting
Dimensions [mm]	75 x 55 x 110

SN0117



Control monitor for flow sensors

VS0200/200VAC

Materials	plastics
-----------	----------

Displays / operating elements

Display	function	11 x LED
---------	----------	----------

Remarks

Pack quantity	1 pcs.
---------------	--------

Electrical connection

terminals: 16 x ...2.5 mm²

Connection

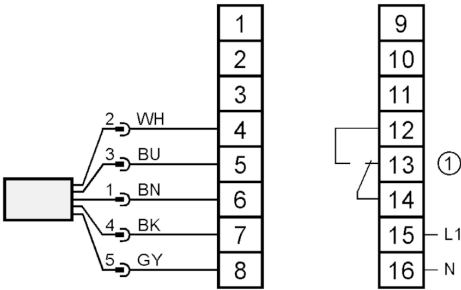

- 1: Relais Flow monitoring
Core colours :
BN = brown
BU = blue
BK = black
WH = white
GY = grey