

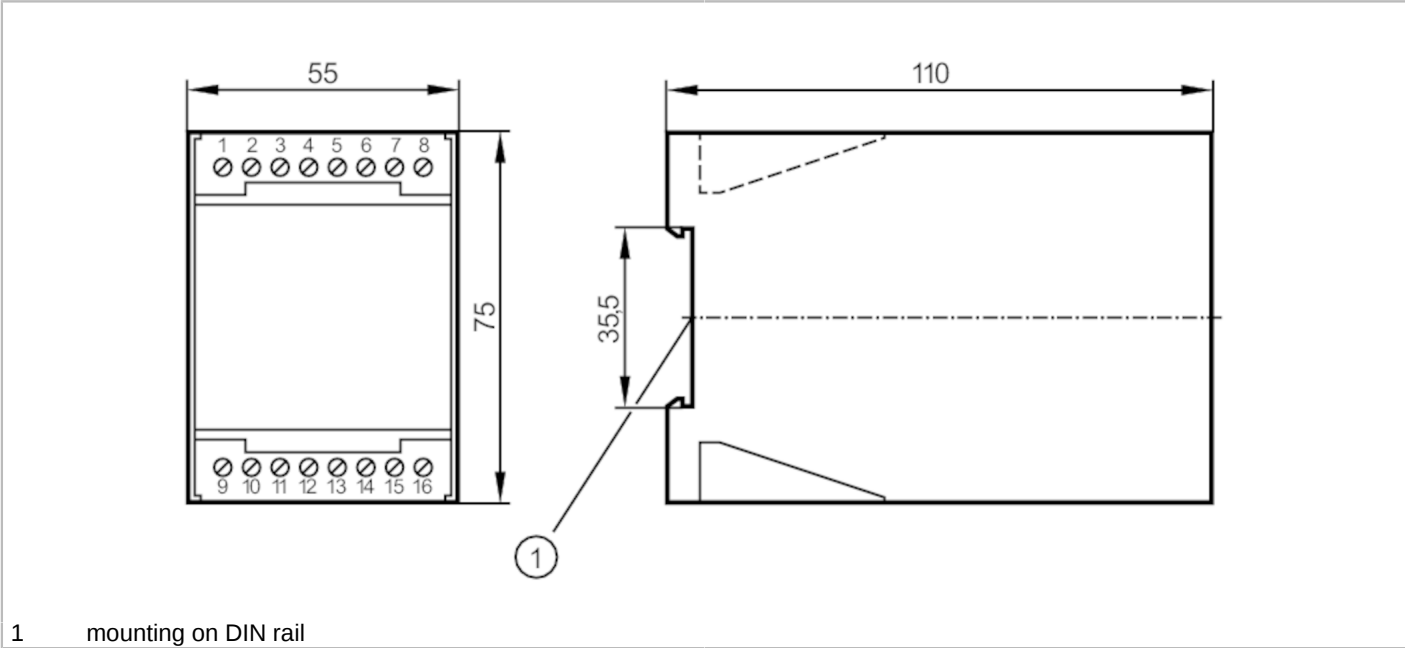

Control monitor for flow sensors

VS0200/230VAC

Article no longer available - archive entry



Application		
Application	Flow monitoring; Temperature monitoring; Wire monitoring	
Electrical data		
Operating voltage tolerance	[%]	-10...10
Operating voltage	[V]	< 230 AC
Max. power consumption	[VA]	3
Power-on delay time	[s]	< 30
Number of channels		1
Outputs		
Electrical design	relay	
Contact rating	4 A, 250 V AC	
Switching function flow monitoring	relay energised when flow is present	
Switching function temperature monitoring	relay de-energised when temperature is exceeded	
Switching function wire break monitoring	relay de-energised in case of wire break and short circuit	
Response times		
Response time	[s]	< 10
Software / programming		
Adjustment of the switch point	potentiometer	
Selection liquids / gases	slide switch	
Switch point setting	potentiometer	
Temperature range	[°C]	20...100



Control monitor for flow sensors

VS0200/230VAC

Repeatability of the set switch point	[K]	4
---------------------------------------	-----	---

Operating conditions

Ambient temperature	[°C]	-25...70
Protection		IP 40
Protection rating terminals		IP 20

Mechanical data

Housing		housing for DIN rail mounting
Dimensions	[mm]	75 x 55 x 110
Materials		plastics

Displays / operating elements

Display	function	11 x LED
	switching status	LED, red
	switching status	LED, red

Remarks

Remarks	If the relay for wire/temperature monitoring is de-energised the relay flow monitoring is also de-energised.	
Pack quantity	1 pcs.	

Electrical connection

terminals: 16 x ...2.5 mm²

Connection

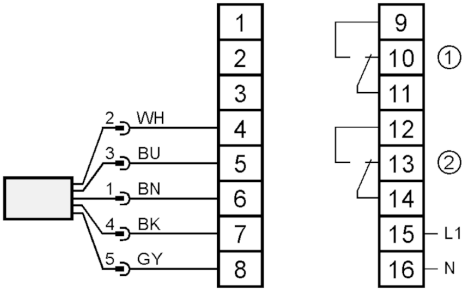

- 1: Relais Wire monitoring / Temperature monitoring
2: Relais Flow monitoring
Core colours :
BN = brown
BU = blue
BK = black
WH = white
GY = grey