

SF323A

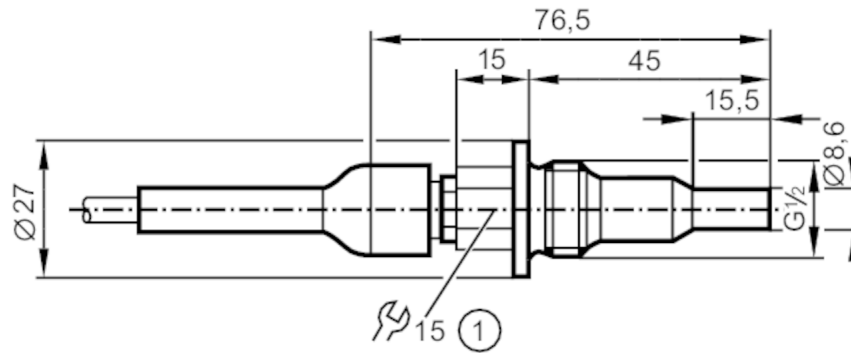

Flow sensor for connection to an evaluation unit

SFR12XBK/2G /6M



1 tightening torque max. 30 Nm



Product characteristics

Probe length L	[mm]	30
Process connection		G 1/2 external thread

Application

Media		Liquids; aggressive media
Medium temperature	[°C]	5...70
Pressure rating	[bar]	30

Liquids

Medium temperature	[°C]	5...70
--------------------	------	--------

Electrical data

Connection to control monitor		VS2000 Exi (PTB 01 ATEX 2075)
-------------------------------	--	-------------------------------

Measuring/setting range

Probe length L	[mm]	30
Liquids		
Setting range	[cm/s]	3...60
Greatest sensitivity	[cm/s]	3...40

Accuracy / deviations

Temperature gradient	[K/min]	7
----------------------	---------	---

Response times

Response time	[s]	2...20
---------------	-----	--------

Liquids

Response time	[s]	2...20
---------------	-----	--------

Operating conditions

Ambient temperature	[°C]	-20...70
Protection		IP 67

Tests / approvals

Approval	DMT 03 ATEX E091; IECEx BVS 06.0007	
ATEX marking	Ex II 2G Ex ia IIC T4 Gb	
Shock resistance	DIN IEC 68-2-27	40 g (11 ms)
Vibration resistance	DIN IEC 68-2-6	10 g (55...2000 Hz)

SF323A



Flow sensor for connection to an evaluation unit

SFR12XBK/2G /6M

MTTF	[ANN]	7927
------	-------	------

Safety classification

Max. internal capacitance	[nF]	1.2
Max. internal inductance	[μH]	6
Temperature class		T4

Mechanical data

Weight	[g]	353
Housing		threaded type
Materials		ceramics (99.7 % Al ₂ O ₃)
Materials (wetted parts)		ceramics (99.7 % Al ₂ O ₃)
Process connection		G 1/2 external thread
Installation length EL	[mm]	45

Remarks

Remarks	In principle, the type test according to 94/9/EC (ATEX) only takes atmospheric conditions into account (0.8...1.1 bar). For pressures outside this range use must be assessed and approved by the user. Adhere to the operating instructions and the type test certificate.
Pack quantity	1 pcs.

Electrical connection

Cable: 6 m, TPE-S; Maximum cable length: 100 m; 5 x 0.34 mm²

Connection

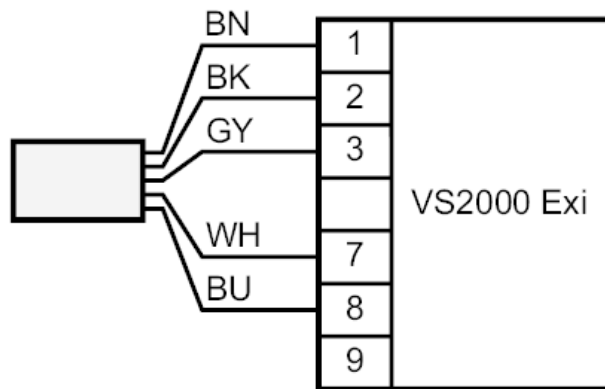

	Core colours :
BN =	brown
BU =	blue
BK =	black
WH =	white
GY =	grey