

## Flow sensor for connection to an evaluation unit

SFR12ABA/20M/PH

Article no longer available - archive entry

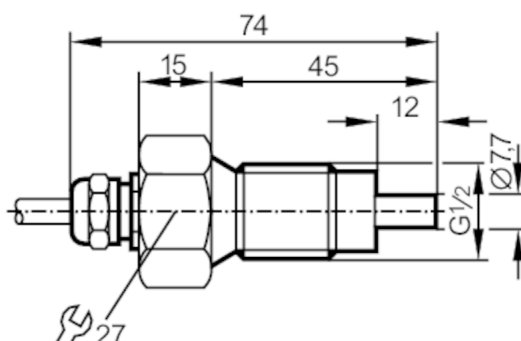

### Product characteristics

Process connection	G 1/2 external thread
--------------------	-----------------------

### Application

Application	high-temperature range
Media	Liquids; Gases
Medium temperature [°C]	-25...80
Pressure rating [bar]	30

### Liquids

Application	high-temperature range
Medium temperature [°C]	-25...80

### Gases

Medium temperature [°C]	-25...80
-------------------------	----------

### Electrical data

Connection to control monitor	VS 0200
-------------------------------	---------

### Measuring/setting range

#### Liquids

Setting range [cm/s]	3...300
Greatest sensitivity [cm/s]	3...60

#### Gases

Setting range [cm/s]	200...2000
Greatest sensitivity [cm/s]	200...800

### Accuracy / deviations

Temperature gradient [K/min]	15
------------------------------	----

### Response times

Response time [s]	1...10
-------------------	--------

#### Liquids

Response time [s]	1...10
-------------------	--------

#### Gases

Response time [s]	1...10
-------------------	--------

# SF3003



## Flow sensor for connection to an evaluation unit

SFR12ABA/20M/PH

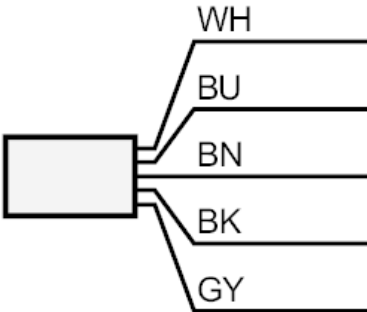
Operating conditions	
Protection	IP 67
Mechanical data	
Housing	threaded type
Materials	stainless steel (1.4305 / 303)
Materials (wetted parts)	stainless steel (1.4305 / 303)
Process connection	G 1/2 external thread
Аксессуары	
Items supplied	sealings: 2 x AMF 30
Remarks	
Pack quantity	1 pcs.
Electrical connection	
Cable: 20 m, PUR / PVC; 5 x 0.34 mm <sup>2</sup>	
Connection	
<div></div>	
<div><div><div>BN =</div><div>BU =</div><div>BK =</div><div>WH =</div><div>GY =</div></div><div>Core colours : brown blue black white grey</div></div>	