

Flow sensor for connection to an evaluation unit

SFR12ABBE1

Article no longer available - archive entry

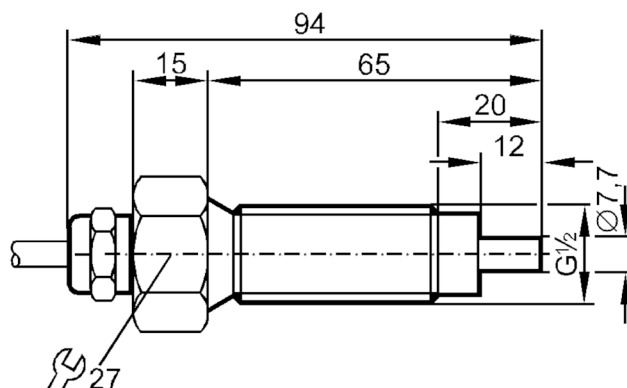

Product characteristics

Process connection	G 1/2 external thread
--------------------	-----------------------

Application

Application	Ex zone 1
Medium temperature [°C]	-25...80
Pressure rating [bar]	40

Liquids

Application	Ex zone 1
Medium temperature [°C]	-25...80

Gases

Medium temperature [°C]	-25...80
-------------------------	----------

Electrical data

Connection to control monitor	VS 0200 Exi
-------------------------------	-------------

Measuring/setting range

Liquids

Setting range [cm/s]	3...300
Greatest sensitivity [cm/s]	3...60

Gases

Setting range [cm/s]	200...2000
Greatest sensitivity [cm/s]	200...800

Accuracy / deviations

Temperature gradient [K/min]	15
------------------------------	----

Response times

Response time [s]	1...10
-------------------	--------

SF0717



Flow sensor for connection to an evaluation unit

SFR12ABBE1

Liquids		
Response time	[s]	1...10
Gases		
Response time	[s]	1...10
Operating conditions		
Protection		IP 67
Mechanical data		
Housing		threaded type
Materials		stainless steel (1.4571/316Ti)
Materials (wetted parts)		stainless steel (1.4571/316Ti)
Process connection		G 1/2 external thread
Remarks		
Pack quantity		1 pcs.
Electrical connection		
Cable: 10 m, TPE-S; 5 x 0.34 mm ²		
Connection		

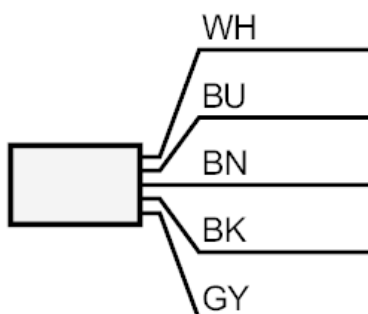

	Core colours :
BN =	brown
BU =	blue
BK =	black
WH =	white
GY =	grey