

## Flow sensor for connection to an evaluation unit

SFN12ADB/US-100

Article no longer available - archive entry

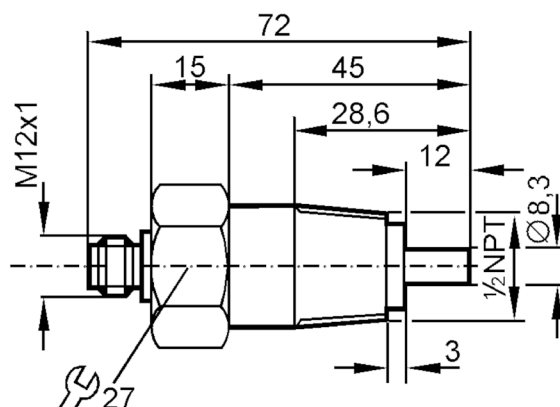

## Product characteristics

Process connection	1/2" NPT
--------------------	----------

## Application

Application	high pressure
Media	Liquids; Gases
Medium temperature [°C]	-25...80
Pressure rating [bar]	300

## Liquids

Application	high pressure
Medium temperature [°C]	-25...80

## Gases

Medium temperature [°C]	-25...80
-------------------------	----------

## Electrical data

Connection to control monitor	VS 0200
-------------------------------	---------

## Measuring/setting range

## Liquids

Setting range [cm/s]	3...300
Greatest sensitivity [cm/s]	3...60

## Gases

Setting range [cm/s]	200...2000
Greatest sensitivity [cm/s]	200...800

## Accuracy / deviations

Temperature gradient [K/min]	15
------------------------------	----

SF0535



Flow sensor for connection to an evaluation unit

SFN12ADB/US-100

Response times		
Response time	[s]	1...10
Liquids		
Response time	[s]	1...10
Gases		
Response time	[s]	1...10
Operating conditions		
Protection		IP 67
Mechanical data		
Housing		threaded type
Materials		stainless steel (1.4571/316Ti )
Materials (wetted parts)		stainless steel (1.4571/316Ti )
Process connection		1/2" NPT
Аксессуары		
Items supplied		sealings: 2 x AMF 30
Remarks		
Pack quantity		1 pcs.
Electrical connection		
Connector: 1 x M12; coding: A; Maximum cable length: 100 m		

Connection	
BN =	Core colours : brown
BU =	blue
BK =	black
WH =	white
GY =	grey