

Flow sensor for connection to an evaluation unit

SFR12ABH

Article no longer available - archive entry

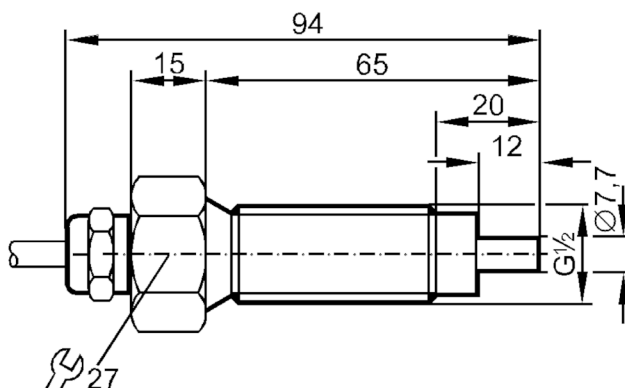

Product characteristics

Process connection	G 1/2 external thread
--------------------	-----------------------

Application

Application	high-temperature range
Media	Liquids; Gases
Medium temperature [°C]	-25...80
Pressure rating [bar]	30

Liquids

Application	high-temperature range
Medium temperature [°C]	-25...80

Gases

Medium temperature [°C]	-25...80
-------------------------	----------

Electrical data

Connection to control monitor	VS 0200
-------------------------------	---------

Measuring/setting range

Liquids

Setting range [cm/s]	3...300
Greatest sensitivity [cm/s]	3...60

Gases

Setting range [cm/s]	100...2000
Greatest sensitivity [cm/s]	100...800

Accuracy / deviations

Temperature gradient [K/min]	15
------------------------------	----



Flow sensor for connection to an evaluation unit

SFR12ABH

Response times	
Response time [s]	2...10
Liquids	
Response time [s]	2...10
Gases	
Response time [s]	2...10
Operating conditions	
Protection	IP 67
Mechanical data	
Housing	threaded type
Materials	Hastelloy C-22 (2.4602)
Materials (wetted parts)	Hastelloy C-22 (2.4602)
Process connection	G 1/2 external thread
Аксессуары	
Items supplied	sealings: 2 x AMF 30
Remarks	
Pack quantity	1 pcs.
Electrical connection	
Cable: 2 m, PUR; Maximum cable length: 100 m; 5 x 0.34 mm ²	
Connection	

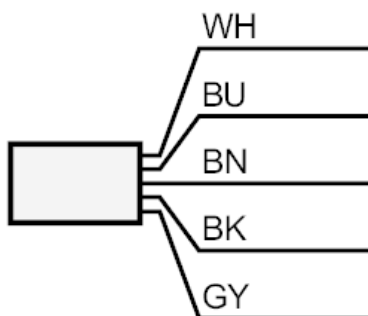

Core colours :

BK = black

BN = brown

BU = blue

WH = white

GY = grey