



## Through-beam sensor receiver

ORE-V/10m

Article no longer available - archive entry

Alternative articles: OR0002

When selecting an alternative article and accessories please note that technical data may differ!

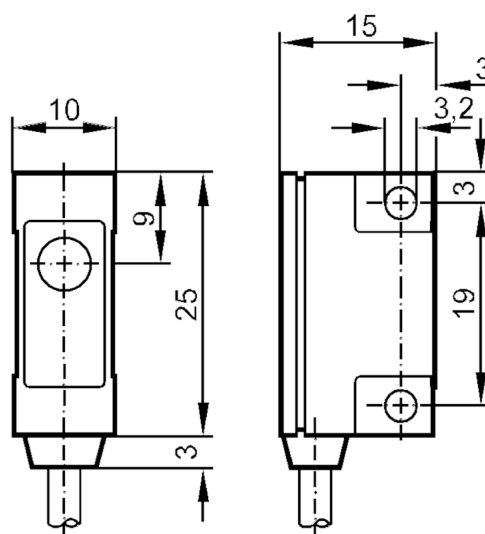

## Product characteristics

Type of light	infrared light
Housing	rectangular

## Application

Function principle	Through-beam sensor
--------------------	---------------------

## Electrical data

Connection to switching amplifiers	yes
Switching amplifiers	Connection to switching amplifiers OV5012, OV0010
Type of light	infrared light
Wave length [nm]	950

## Outputs

Short-circuit protection	no
Overload protection	no

## Detection zone

Transmitter / receiver	receiver
Range [m]	< 2

## Operating conditions

Ambient temperature [°C]	-20...80
Protection	IP 67

# OR0005



## Through-beam sensor receiver

ORE-V/10m

### Tests / approvals

MTTF	[ANN]	49633
------	-------	-------

### Mechanical data

Weight	[g]	0.125
Housing		rectangular
Materials		PPO modified
Lens alignment		side lens

### Аксессуары

Items supplied	Angle bracket: 1, E20212
----------------	--------------------------

### Remarks

Pack quantity	1 pcs.
---------------	--------

### Electrical connection

Cable: 10 m; 1 x 0.14 mm<sup>2</sup>

### Connection

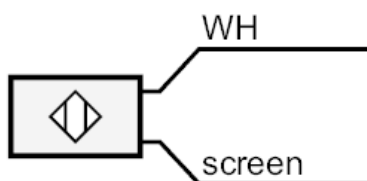

WH = Core colours :  
screen = white  
screen