

Clamp fitting for process sensors

MOUNTING ADAPTER NPT1/D22

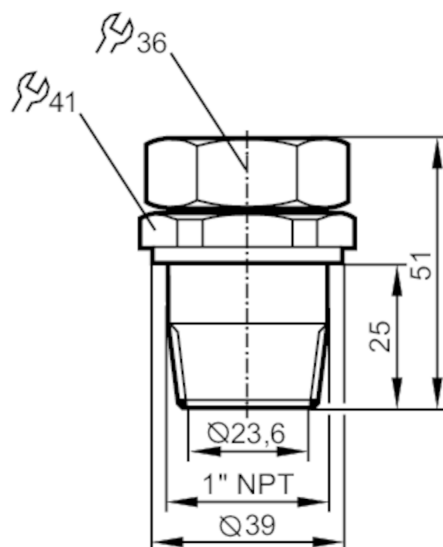

Application		
Design		for climatic tube LK, LI
Installation		Clamp fitting
Pressure rating	[bar]	0.5
Operating conditions		
Ambient temperature	[°C]	0...80
Mechanical data		
Weight	[g]	258.5
Materials		stainless steel; NBR; brass
Tightening torque	[Nm]	6...8
Sensor connection		Ø 22 mm
Process connection		threaded connection 1" NPT
Remarks		
Pack quantity		1 pcs.