

# E40213

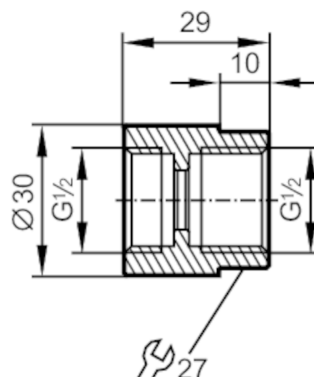

## Mounting adapter for flow sensors

SCREW-IN ADAPTER 1/2" SM



### Reg31

Application	
Design	for flow sensors SM6
Tests / approvals	
Pressure Equipment Directive	A possible classification to PED depends on the application and has to be carried out by the user / operator.
Safety instructions	The compatibility between medium and product material has to be checked in all applications.
Mechanical data	
Weight [g]	178
Materials	Adapter: stainless steel (1.4404 / 316L); Gasket: Centellen 18,5 x 12 x 3 mm
Sensor connection	G 1/2
Process connection	threaded connection G 1/2
Аксессуары	
Items supplied	O-rings: 2
Remarks	
Pack quantity	2 pcs.