

E40208

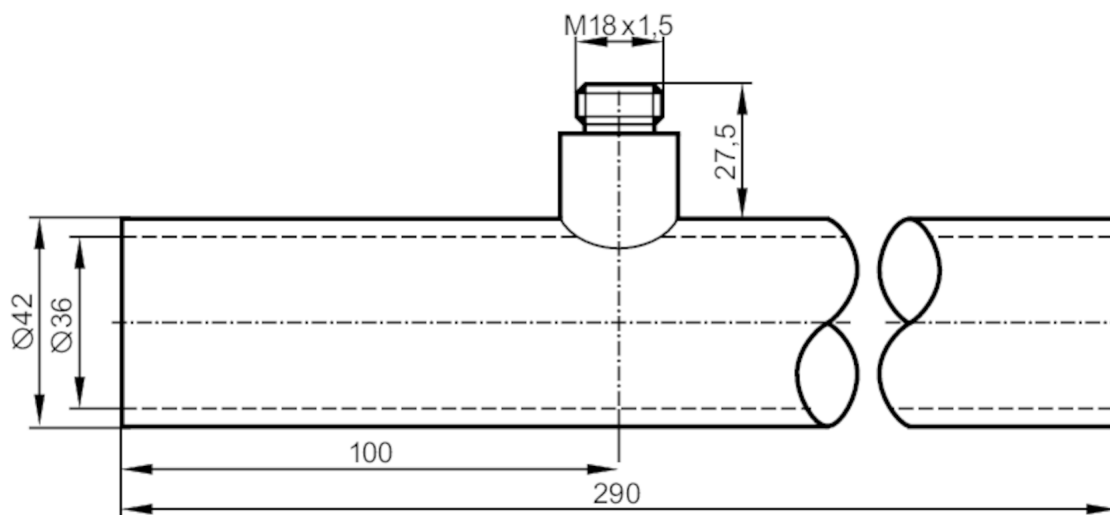

T-piece

T-PIECE D 42X3-M18X1.5



Application

Design	for sensors with process connection M18x1,5
Application	for industrial applications
Media	liquids and gases
Pressure rating [bar]	30

Tests / approvals

Pressure Equipment Directive	A possible classification to PED depends on the application and has to be carried out by the user / operator.
Safety instructions	The compatibility between medium and product material has to be checked in all applications.

Mechanical data

Weight [g]	1061.4
Materials	stainless steel (1.4571/316Ti)
Sensor connection	M18 x 1,5
Process connection	welding adapter Ø 42 mm

Remarks

Pack quantity	1 pcs.
---------------	--------