

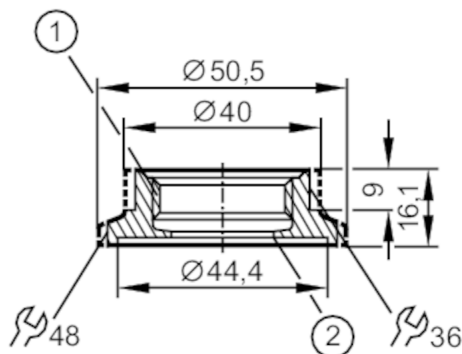

## Mounting adapter for process sensors

ADAPT IFM-SUEDMO DN25

phase-out article



- 1 Aseptoflex thread  
2 Aseptoflex sealing edge

EC 1935/2004 

## Application

Pressure rating	[bar]	16
-----------------	-------	----

## Tests / approvals

Pressure Equipment Directive	A possible classification to PED depends on the application and has to be carried out by the user / operator.
Safety instructions	The compatibility between medium and product material has to be checked in all applications.

## Mechanical data

Weight	[g]	144.8
Materials	stainless steel (1.4404 / 316L)	
Sensor connection	Aseptoflex	
Process connection	Clamp DN25	
Surface characteristics Ra/Rz of the wetted parts	0.4 / 4	

## Remarks

Pack quantity	1 pcs.
---------------	--------