

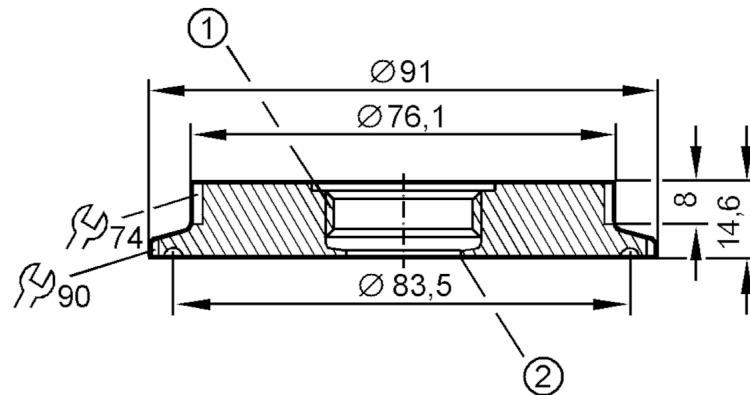

Process adapter Tri-Clamp

ADAPT IFM-CLAMP ISO2852/3

phase-out article



- 1 Aseptoflex thread
2 Aseptoflex sealing edge

EC 1935/2004 FDA

Application		
Pressure rating	[bar]	10
Tests / approvals		
Pressure Equipment Directive	A possible classification to PED depends on the application and has to be carried out by the user / operator.	
Safety instructions	The compatibility between medium and product material has to be checked in all applications.	
Mechanical data		
Weight	[g]	554.4
Materials	stainless steel (1.4404 / 316L)	
Sensor connection	Aseptoflex	
Process connection	Clamp DN65 (3") DIN 32676 (ISO 2852)	
Surface characteristics Ra/Rz of the wetted parts	0.4 / 4	
Hygienic equipment class to DIN 11866	H4	
Remarks		
Pack quantity	1 pcs.	